

# LUXURY FIREPLACE MANTELS

DreamCast concrete products



# DreamCast

[dreamcastdesign.com](http://dreamcastdesign.com)





# Table of contents

Chateau Mantel.....	<b>4</b>
Venezia Mantel.....	<b>9</b>
Regal Mantel.....	<b>11</b>
Tori Mantel.....	<b>13</b>
Westminster Mantel.....	<b>17</b>
French Country Mantel.....	<b>19</b>
Britannia Mantel.....	<b>25</b>
Margaret Mantel.....	<b>29</b>
Fransk Mantel.....	<b>31</b>
Tuscany Mantel.....	<b>33</b>
Torino Mantel.....	<b>35</b>
Bolero Mantel.....	<b>37</b>
Whistler Mantel.....	<b>41</b>
Bracket Mantel.....	<b>43</b>
Bowen Mantel.....	<b>45</b>
Vogue Mantel.....	<b>51</b>
Concrete Panels.....	<b>53</b>
Definition Mantel.....	<b>61</b>
Hearth Options.....	<b>63</b>
Custom Mantels.....	<b>65</b>
Colors and Textures.....	<b>71</b>
Available Services.....	<b>73</b>





# Chateau Mantel

*Enduring. Versatile.*

A timeless picture-frame design the Chateau mantel has elegant curves to soften its profile and lend the ideal frame for contemporary and traditional spaces alike.

Chateau Mantel  
Simply White, Smoothcast



Dimensions:  
**64 1/2" W x 52 3/4" H x 12" D**



# Dimensions

Standard sizes can be adjusted by creating classic masonry corners for the perfect fit including width, height and depth.

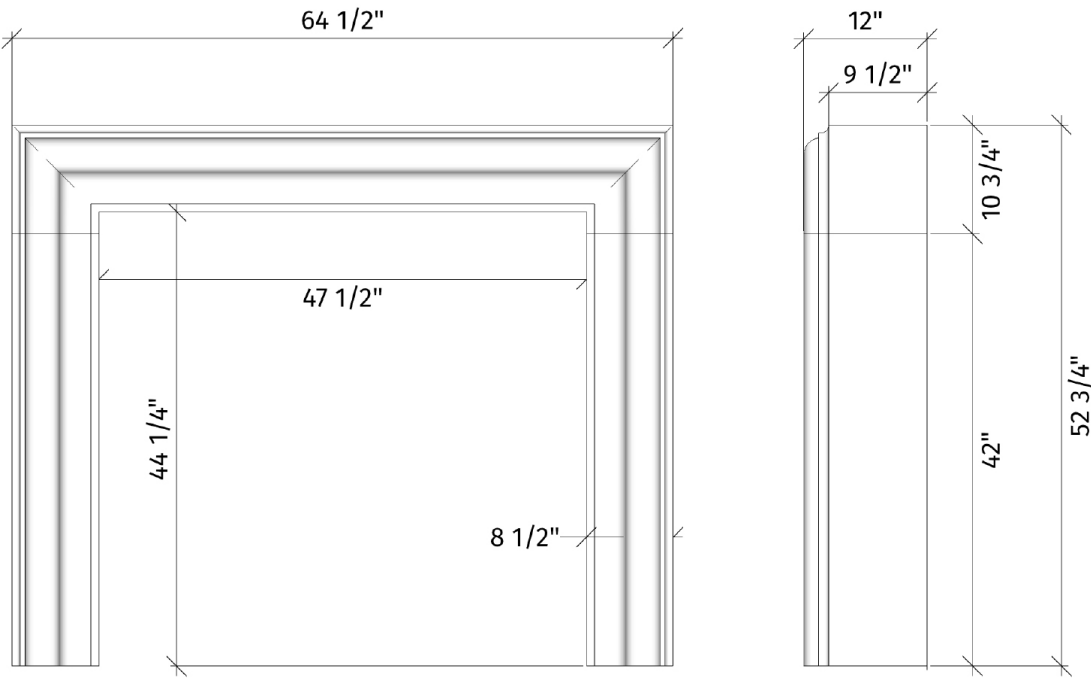

**dreamcastdesign.com**  
Visit our website for a full cutsheet and package details.

**Chateau Mantel**  
Charcoal, Smoothcast - Custom size





Chateau Mantel  
Simply White, Smoothcast

Featured on  
**NETFLIX**

**DREAM HOME  
MAKEOVER**



Venezia Mantel  
Moonlight, Old World

Classical Details

The Venezia is a classical chimneypiece with an overmantel stylized in the elegant manner of the mantels of the palazzo for the Duke of Venice.

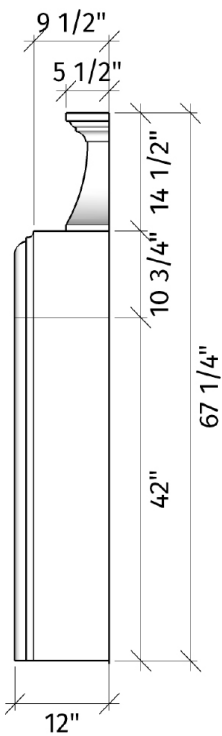
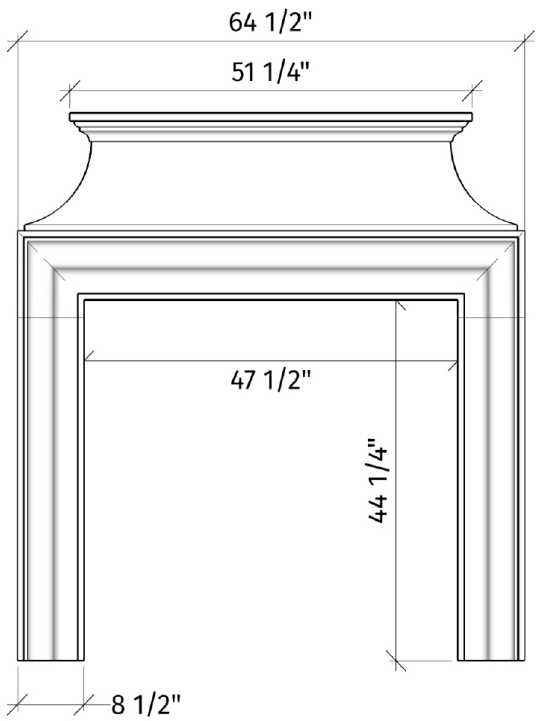

Dimensions:  
**64 1/2" W x 67 1/4" H x 12" D**



**[dreamcastdesign.com](http://dreamcastdesign.com)**  
Visit our website for a full cutsheet  
and package details.

As Seen on





# Regal Mantel

*Classic. Elemental.*

The Regal mantels simple elegance gives it a traditional charm without the typical visual weight of classic styles.

*Its clean open lines allow it to be dressed up or down to suit either family room or formal interiors.*



Dimensions:  
**72"W x 44 1/4"H x 15"D**  
**60"W x 44 1/4"H x 15"D**  
*both widths available in a grand variation at 50 1/2" height as well*



**[dreamcastdesign.com](http://dreamcastdesign.com)**  
Visit our website for a full cutsheet and package details.

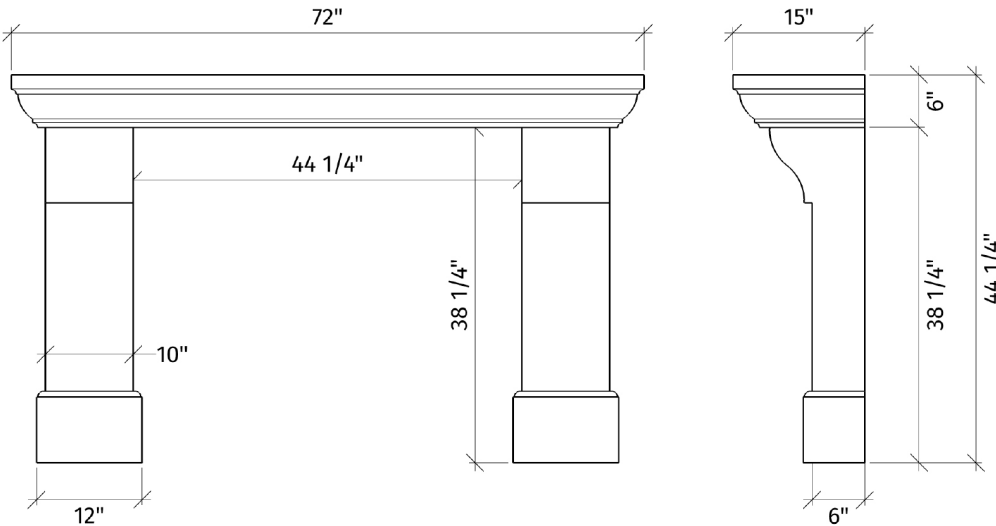

**Regal Mantel**  
Cloud White, Smoothcast - Custom size





**Tori Mantel**  
London Fog, Smoothcast

As seen on  
**NETFLIX**  
DREAM HOME  
MAKEOVER

# Tori Mantel

*Modern. Impact.*

Tori mantel is a modern surround with strong lines for a distinct contemporary look. Highly adjustable dimensions make it easy to suit a variety of spaces.

*This design is popular to pair with panels for a dramatic floor to ceiling effect.*



Dimensions:

**72"W x 60"W x 6"D**

*Custom width and depths available.*



**[dreamcastdesign.com](https://dreamcastdesign.com)**

Visit our website for a full cutsheet and package details.

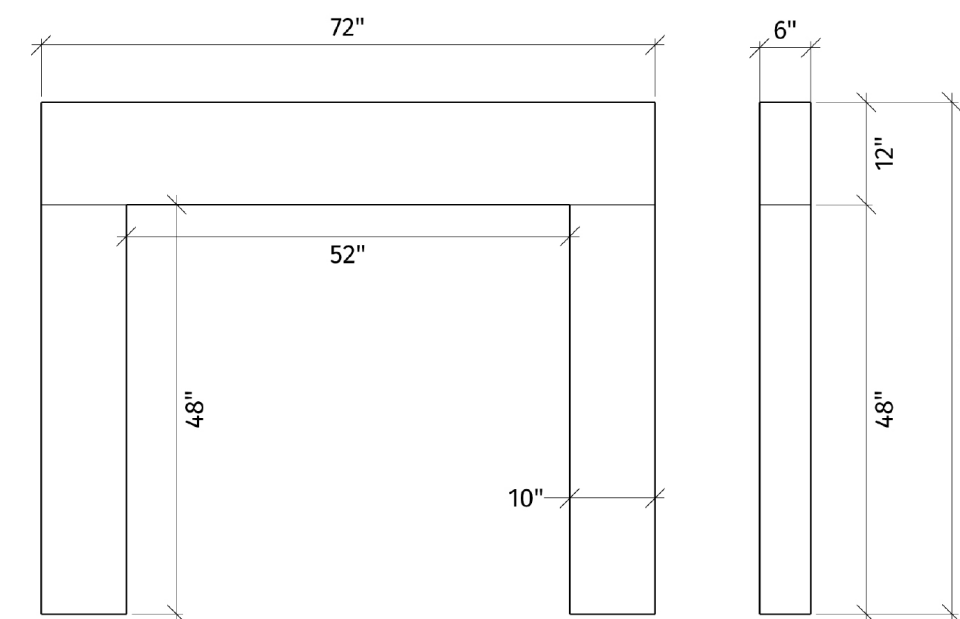





Tori Mantel w/Panels  
Charcoal, Smoothcast



# Westminster Mantel

*Transitional. Masterpiece.*

The Westminster mantel combines strong right angles with feminine curves to illustrate a transitional interior.

*From farmhouse charm to parisian chic this mantel captures any era.*



Dimensions:  
**72"W x 58 3/4"H x 10"D**  
Adjustable height



**[dreamcastdesign.com](http://dreamcastdesign.com)**  
Visit our website for a full cutsheet and package details.

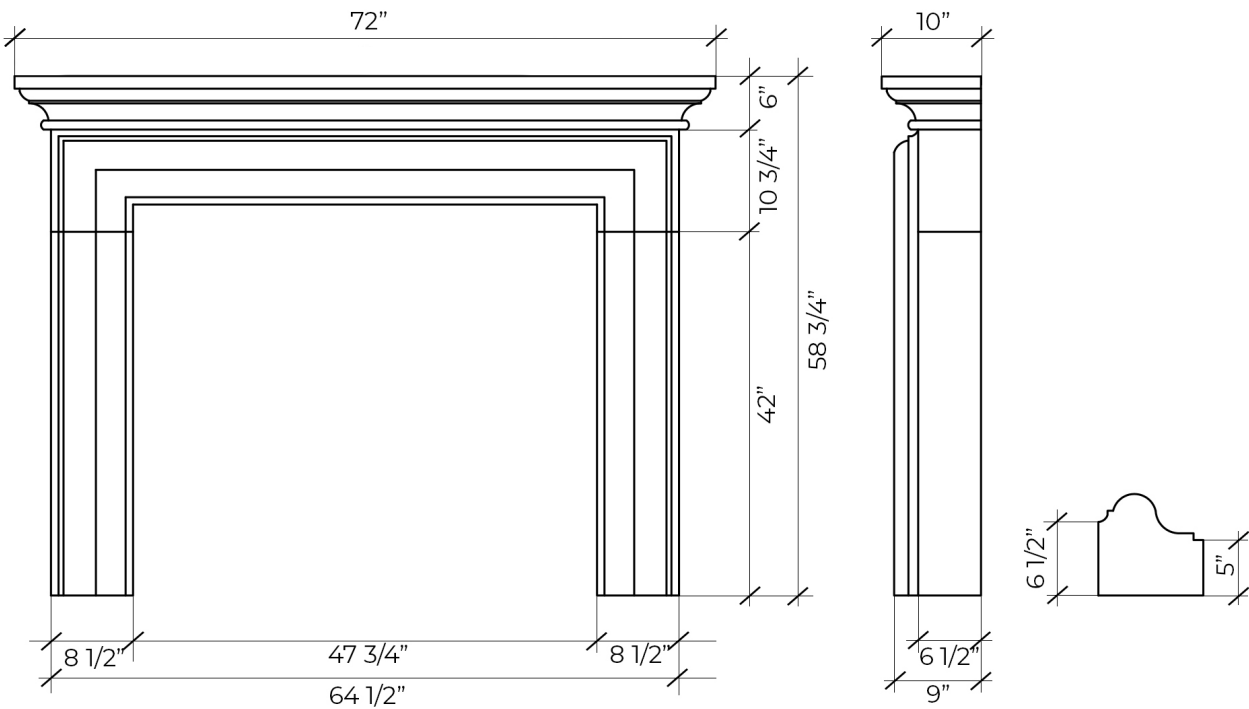

**Westminster Mantel**  
Mist, Smoothcast





French Country Mantel

Simply White, Old World  
shown with customized posts

Timeless  
Design

Warmth.  
Drama.  
Purpose.

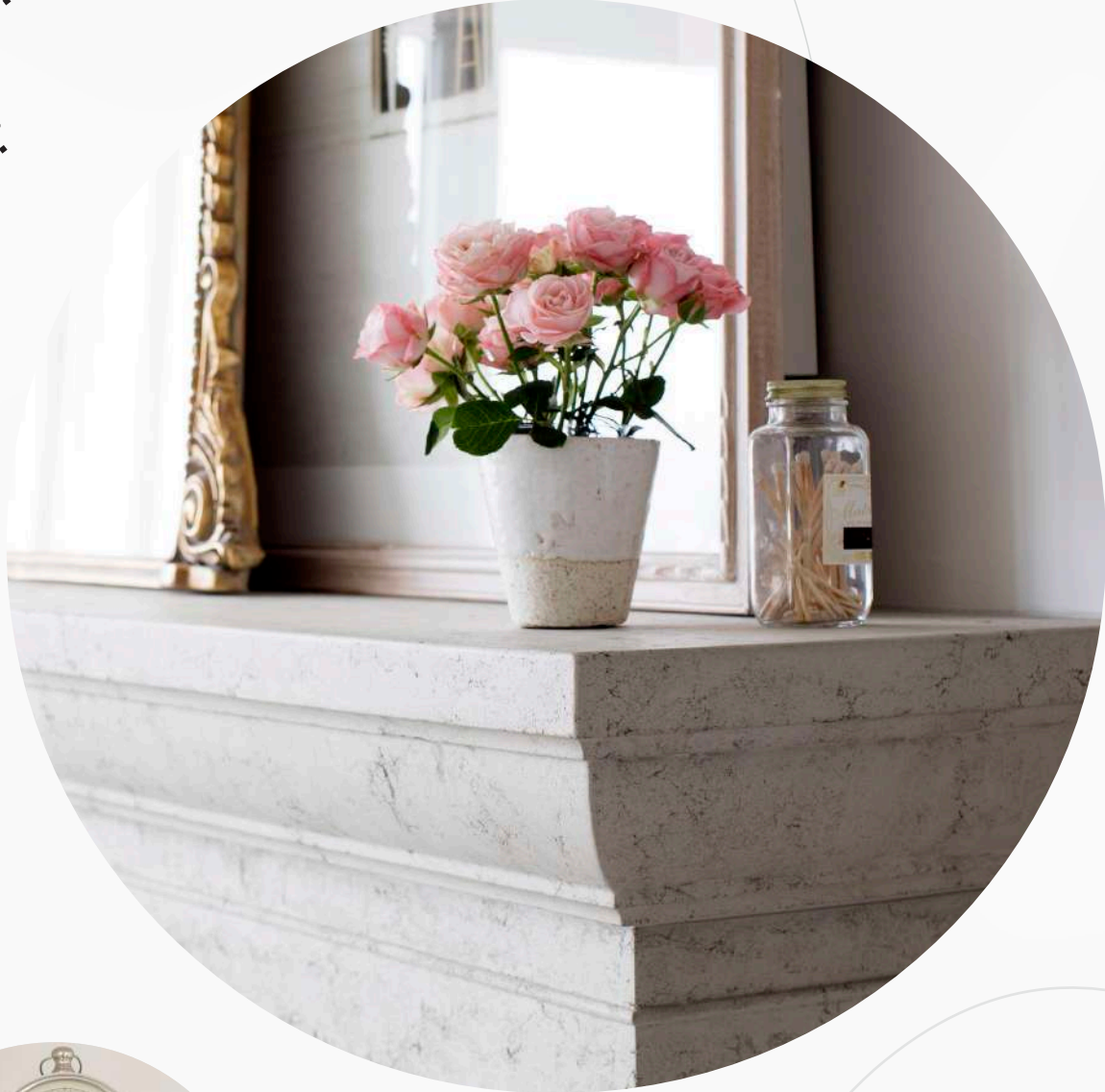



# French Country Mantel

Our iconic French Country mantel embraces a romantic elegance with a visual texture that creates a stunning focal point for great rooms and living spaces.



Dimensions:

**72"W x 53 3/4"H x 15"D**

**60"W x 53 3/4"H x 15"D**

*Both widths available in a grand variation at 60" height as well*



**[dreamcastdesign.com](http://dreamcastdesign.com)**

Visit our website for a full cutsheet and package details.

*Standard sizes can be adjusted by creating classic masonry corners for the perfect fit including, width, height and depth.*

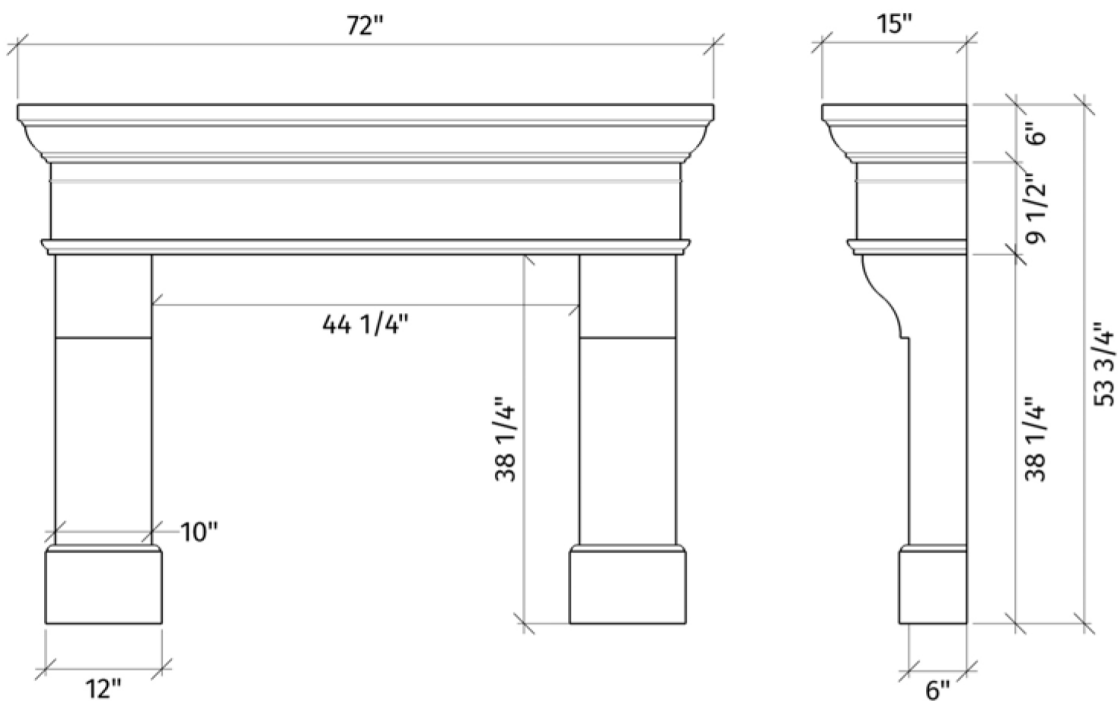

French Country Mantel  
Simply White, Smoothcast





French Country Mantel

Simply White, Old World



# Britannia Mantel

*Keynote. Stylish.*

With a clean profile this classic style effortlessly accentuates transitional or classic interiors. Emblematic of traditional English homestead fireplaces the Britannia mantel has an ageless appeal.



Dimensions:

**72"W x 51 1/4"H x 10"D**

**60"W x 51 1/4"H x 10"D**

*Both widths available in a grand variation at 60" height as well*



**[dreamcastdesign.com](http://dreamcastdesign.com)**

Visit our website for a full cutsheet and package details.

*Standard sizes can be adjusted by creating classic masonry corners to adjust width. Custom heights available.*

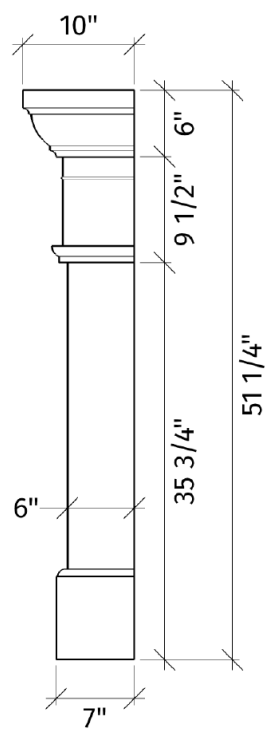
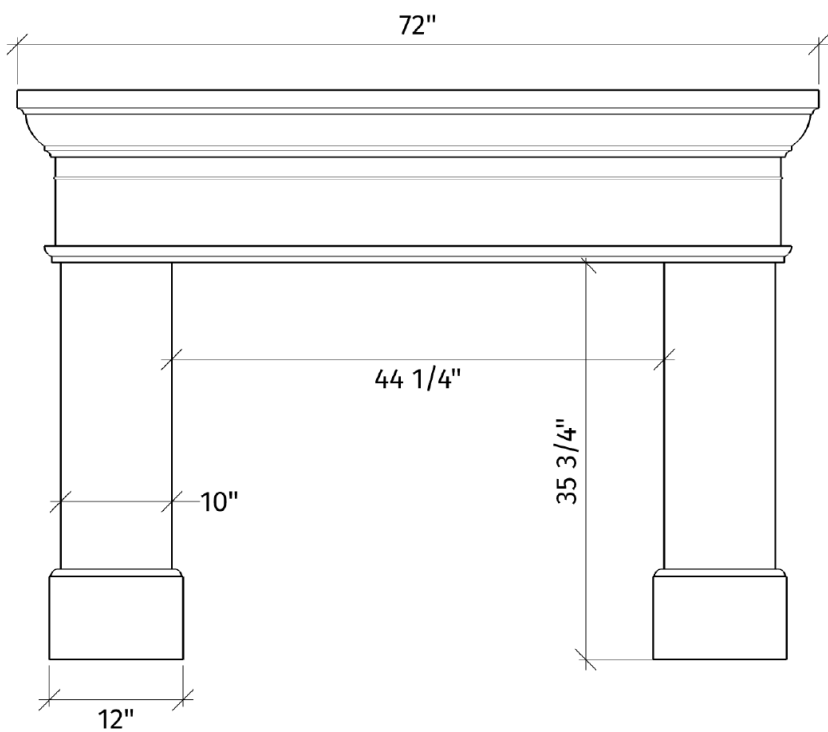

**Britannia Mantel**  
Simply White, Smoothcast  
*Shown with raised hearth*





**Britannia Mantel**  
Simply White, Smoothcast



ELEGANT · AIRY · REFINED

Customize the height of the posts on a Britannia to fit larger fireplace openings and achieve the perfect height for your space.





Margaret Mantel  
Ice White, Smoothcast

# Margaret Mantel

*Classic. Charming.*

Elegantly curved with a strong square picture frame presence the Margaret mantel is the perfect focal point for a luxurious space. Its classic charm works with a variety of styles for both casual and more formal rooms.



Dimensions:  
**56 1/2"W x 47 1/2"H x 8"D**



**[dreamcastdesign.com](https://dreamcastdesign.com)**  
Visit our website for a full cutsheet and package details.

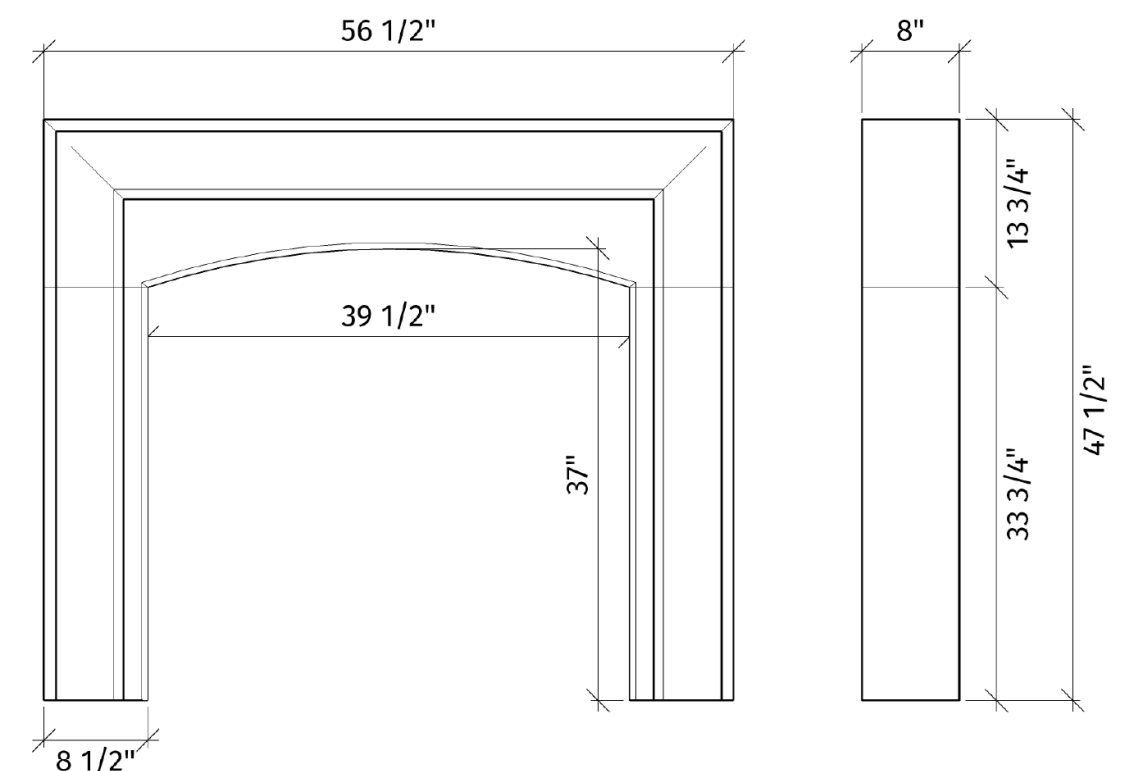



# Fransk Mantel

*Minimal. Transitional.*

Designed for rooms where space is at a premium the Fransk mantel enables to create a keynote feature without compromise to floor layout. This mantel maintains its classical details with a modernized twist to pair with many design styles.



Dimensions:

**67 3/4"W x 50 1/2"H x 7"D**

Adjustable height



**[dreamcastdesign.com](https://dreamcastdesign.com)**

Visit our website for a full cutsheet and package details.

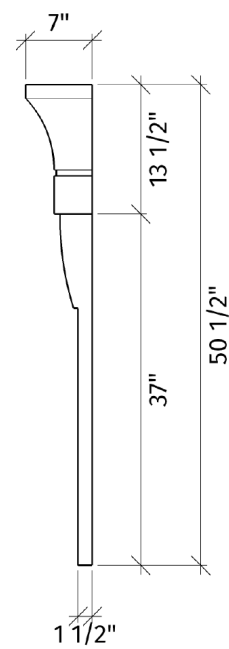
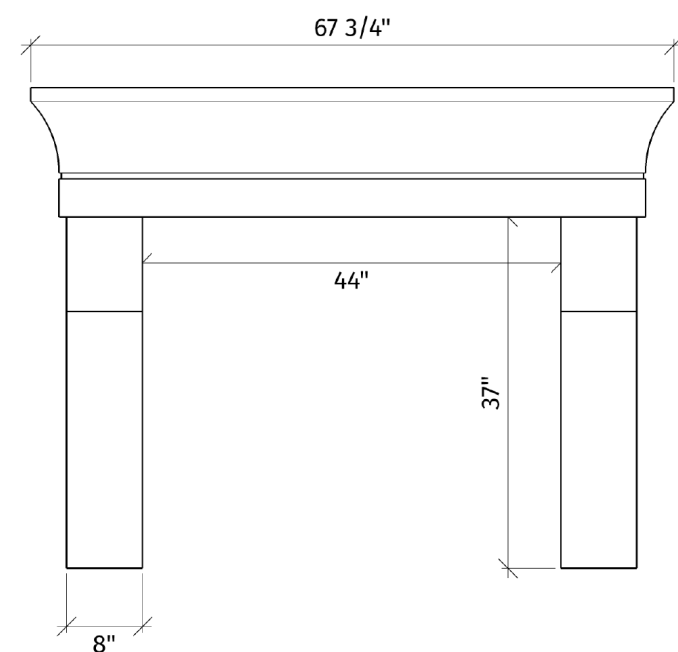

**Fransk Mantel**  
Chalk, Smoothcast





## Tuscany Mantel

London Fog, Old World,  
Customized build out/extension

# Tuscany Mantel

*Refined. Graceful.*

With luxurious curves the Tuscany mantel exemplifies dignified interiors of ageless style. Keeping to the foundation of the design without opulence, this mantel complements both classical refinement and more textural modern aesthetics.



Dimensions:  
**72 1/2"W x 58 3/4"H x 11 1/2"D**



**[dreamcastdesign.com](http://dreamcastdesign.com)**  
Visit our website for a full cutsheet and package details.

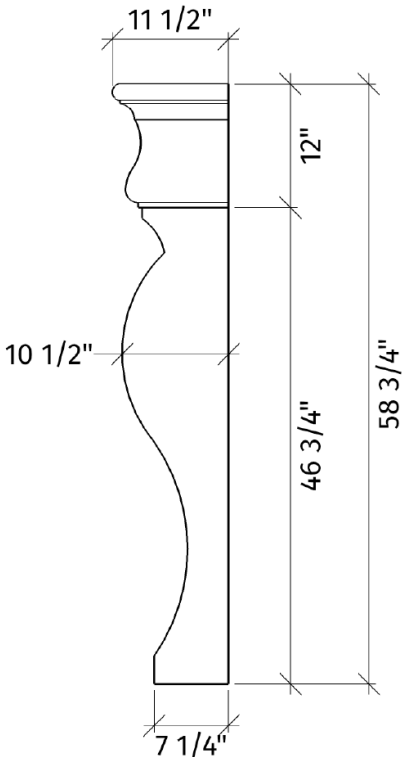
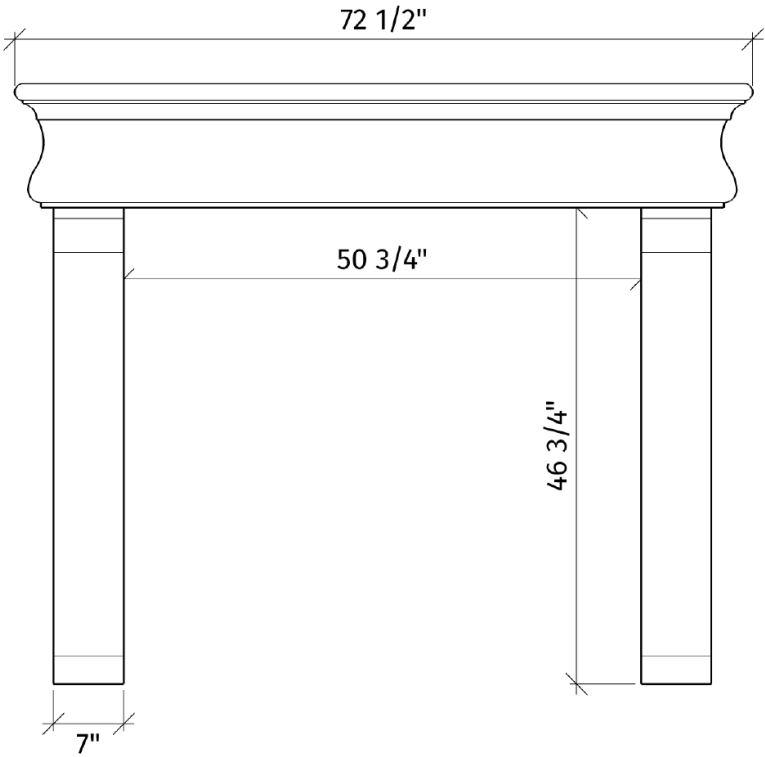



# Torino Mantel

*Contemporary. Classic.*

The Torino mantel is the perfect blend of traditional mantel charm with the clean lines of contemporary design. The streamlined design stays faithful to the classic mantel flare without adding fuss, and leaves plenty of space for impressive feature fires.



Dimensions:  
**72"W x 56 1/4"H x 13"D**  
**60"W x 56 1/4"H x 13"D**  
*Adjustable height*



**[dreamcastdesign.com](http://dreamcastdesign.com)**  
Visit our website for a full cutsheet  
and package details.

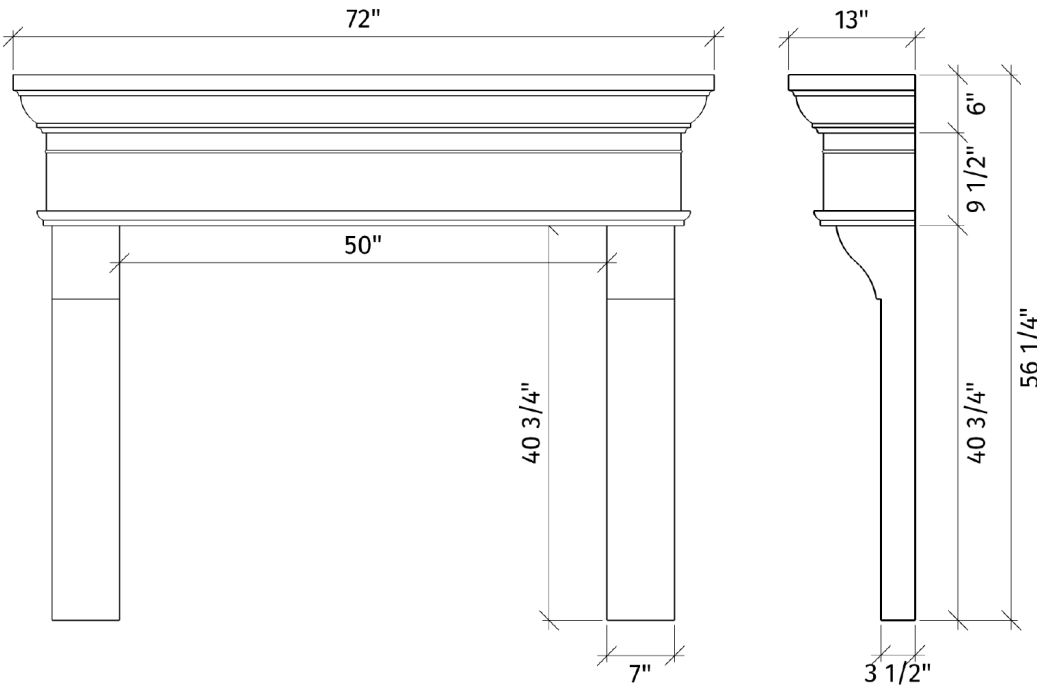

**Torino Mantel**  
Simply White, Old World





## Bolero Mantel

Ice White, Old World

# Bolero Mantel

*Sweeping. Vogue.*

With an elegant arch the Bolero mantel is a stately centerpiece. This provencal design is grand without overtaking floor space, and still maintains plenty of mantel room. Inspired by the sweeping colonnades of Catalanian courtyards this mantel has an enduring charm.



Dimensions:  
**72"W x 51"H x 10"D**



**[dreamcastdesign.com](https://dreamcastdesign.com)**  
Visit our website for a full cutsheet  
and package details.

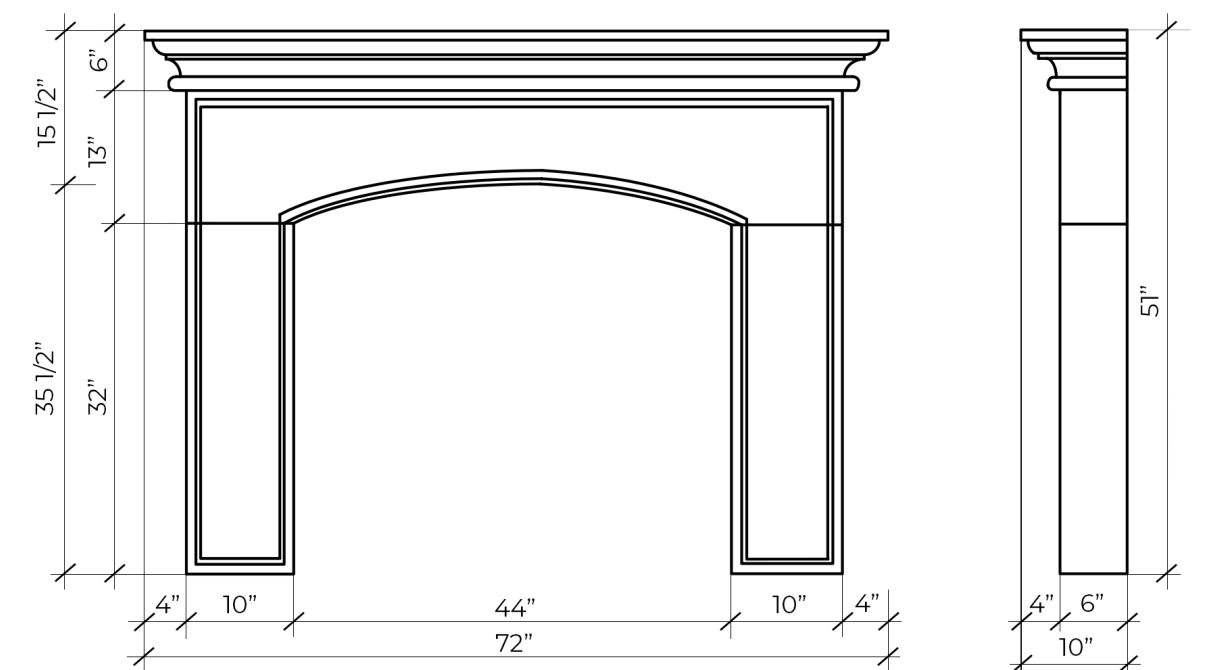





Bolero Mantel  
Mist, Smoothcast



# Whistler Mantel

*Heritage. Keynote.*

The Whistler mantel exemplifies architectural fireplace style. Featuring a sweeping mantel that tucks into a tailored profile this design was inspired by the robust fireplace found in Churchill's office.



Dimensions:  
**73"W x 54 1/4"H x 12 1/2"D**  
Adjustable height



**[dreamcastdesign.com](http://dreamcastdesign.com)**  
Visit our website for a full cutsheet  
and package details.

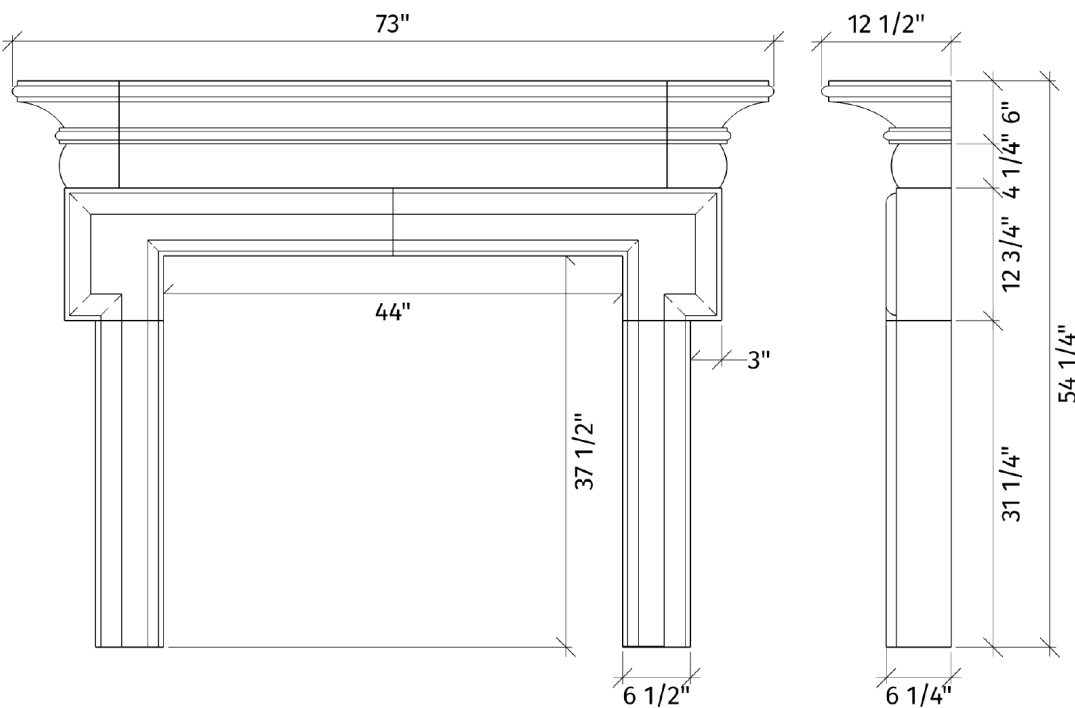

**Whistler Mantel**  
Cloud White, Smoothcast



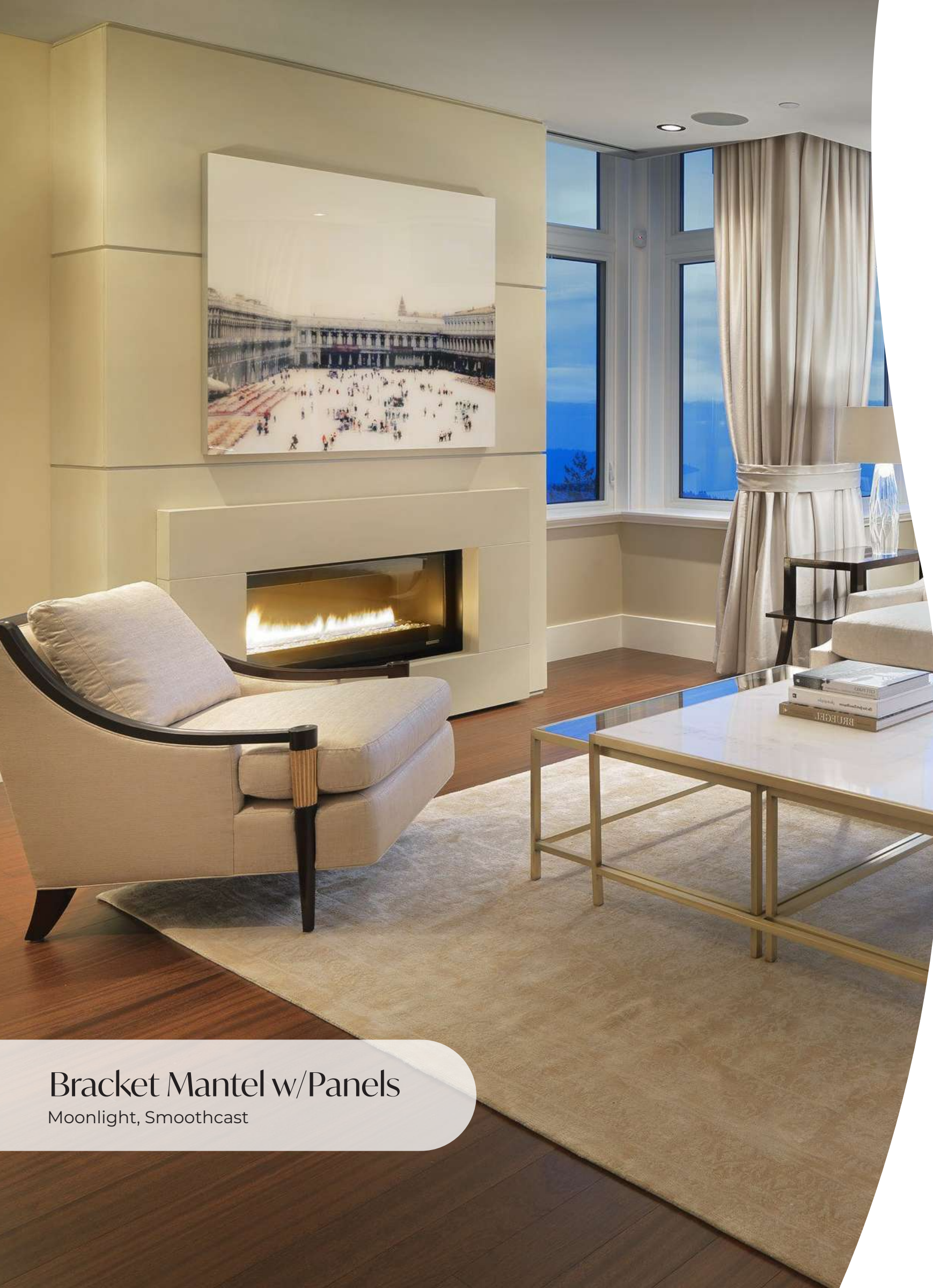

Bracket Mantel w/Panels  
Moonlight, Smoothcast

# Bracket Mantel

*Modern. Definitive.*

Bracket mantel is a modern surround that picture frames the fire for a simple and dramatic effect. The hefty profile grants a further emphasis to the minimalist look with a distinct visual quality unlike tile. This design is popular to pair with panels for floor to ceiling wall features.



Dimensions:  
**UP TO 96"W x UP TO 62"H x 6"D**



**[dreamcastdesign.com](http://dreamcastdesign.com)**  
Visit our website for a full cutsheet and package details.  
*All pieces can be trimmed to suit.  
Custom width and depths available.*

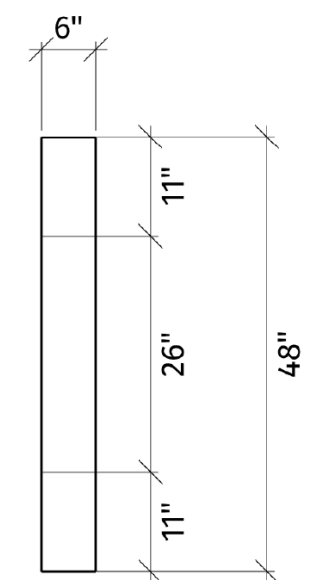
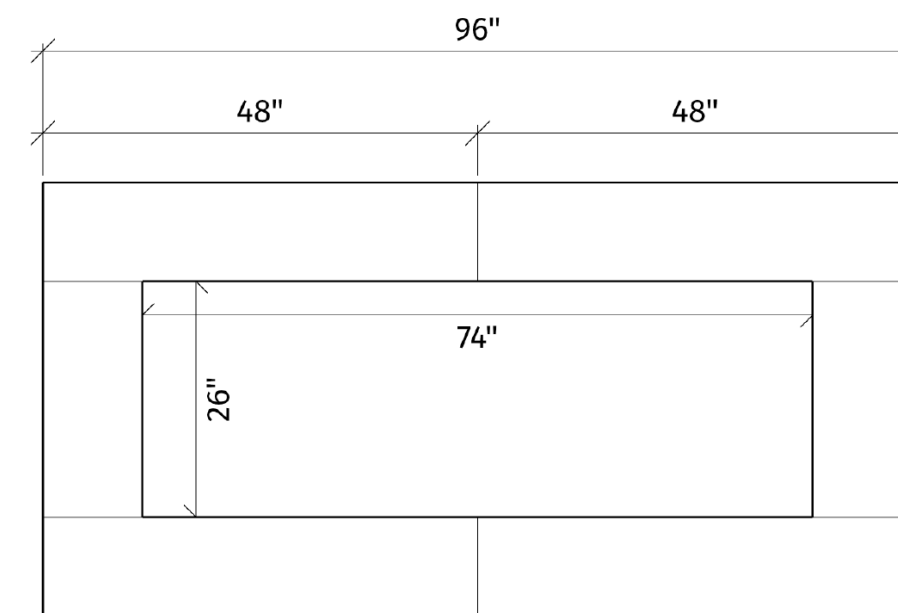



# Bowen Mantel

*Transitional. Clean.*

Blending the soft curves of classic architecture with a bold picture frame approach this design easily works into many interior styles.

The flexibility of the Bowen mantel is furthered by the option to frame a linear fireplace for a floating design.



Dimensions:

**UP TO 80"W x UP TO 64"H x 6"D**

*Dimensions shown are maximum size.*

*All pieces can be trimmed to suit.*



**[dreamcastdesign.com](http://dreamcastdesign.com)**

Visit our website for a full cutsheet and package details.

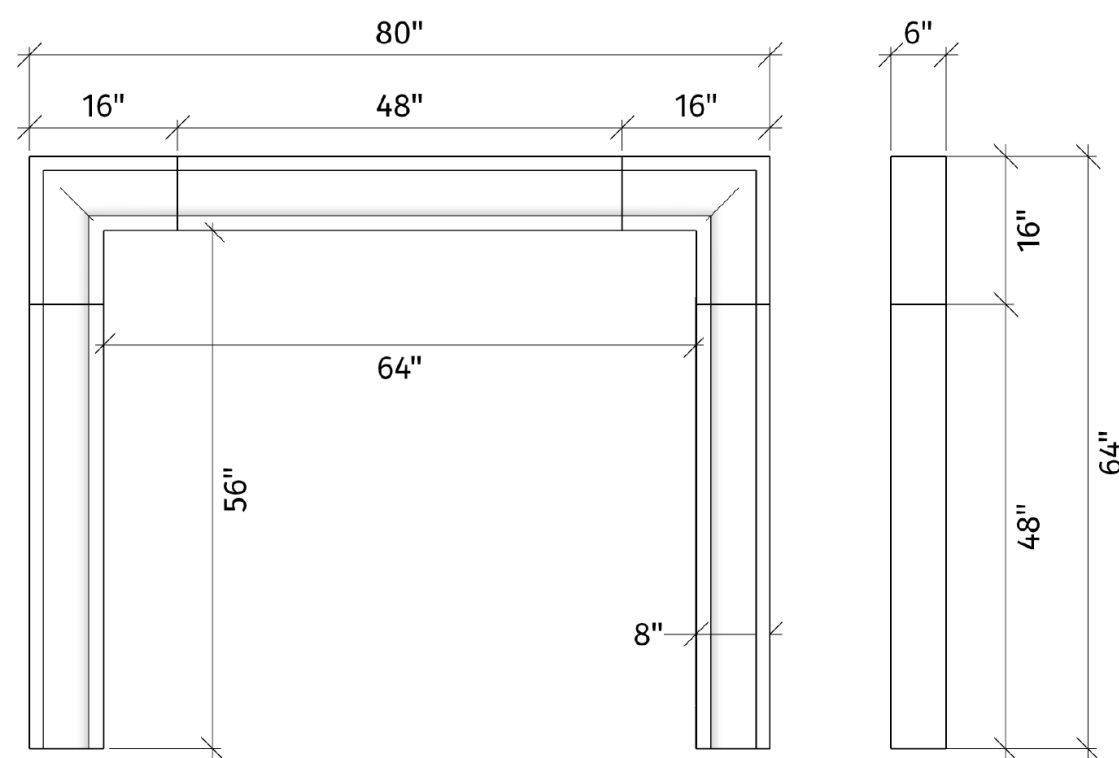

**Bowen Mantel**  
London Fog, Smoothcast





**Bowen Mantel**  
Simply White, Limestone

Featured on



Bowen mantel can wrap around linear and square fireplaces for a striking transitional look. Either floated or floor-mounted the profile works very well in compact spaces as well.



# Flexibility

*Modern  
fireplace  
design*

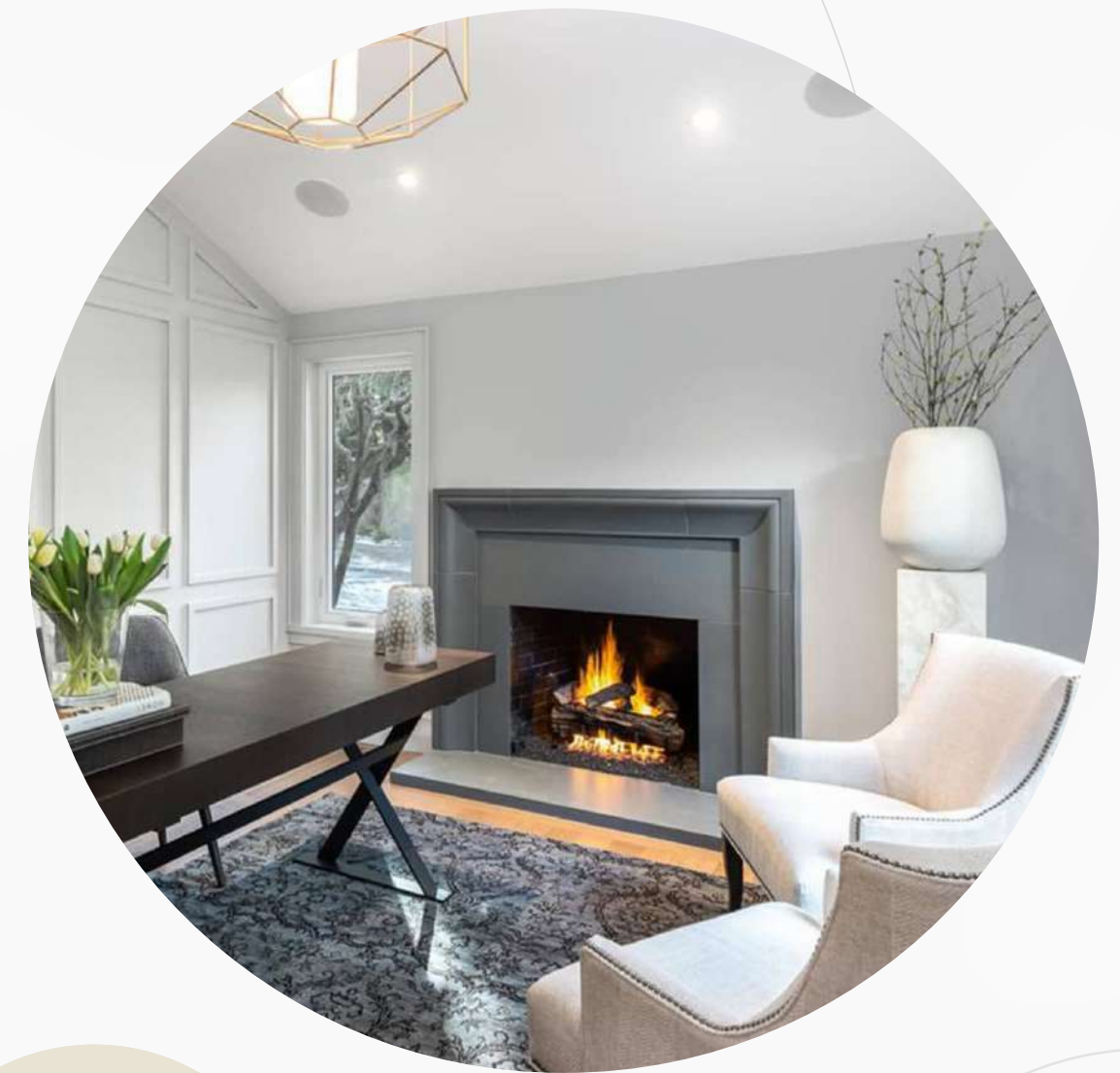

**Bowen Mantel w/Panel**

Mist, Smoothcast  
shown with panels





Vogue Mantel  
Mist, Smoothcast

# Vogue Mantel

*Exclusive. Modern.*

The Vogue mantel is a highly customizable design to create the perfect centerpiece for a room. A picture frame surround slopes in to draw the eye to the flickering firelight. The strong angles create a dramatic look that lends this compact design significant visual emphasis.



Dimensions:  
**72"W x 48"H x 6"D**  
**60"W x 40"H x 6"D**  
All dimensions can be adjusted



**[dreamcastdesign.com](http://dreamcastdesign.com)**  
Visit our website for a full cutsheet and package details.

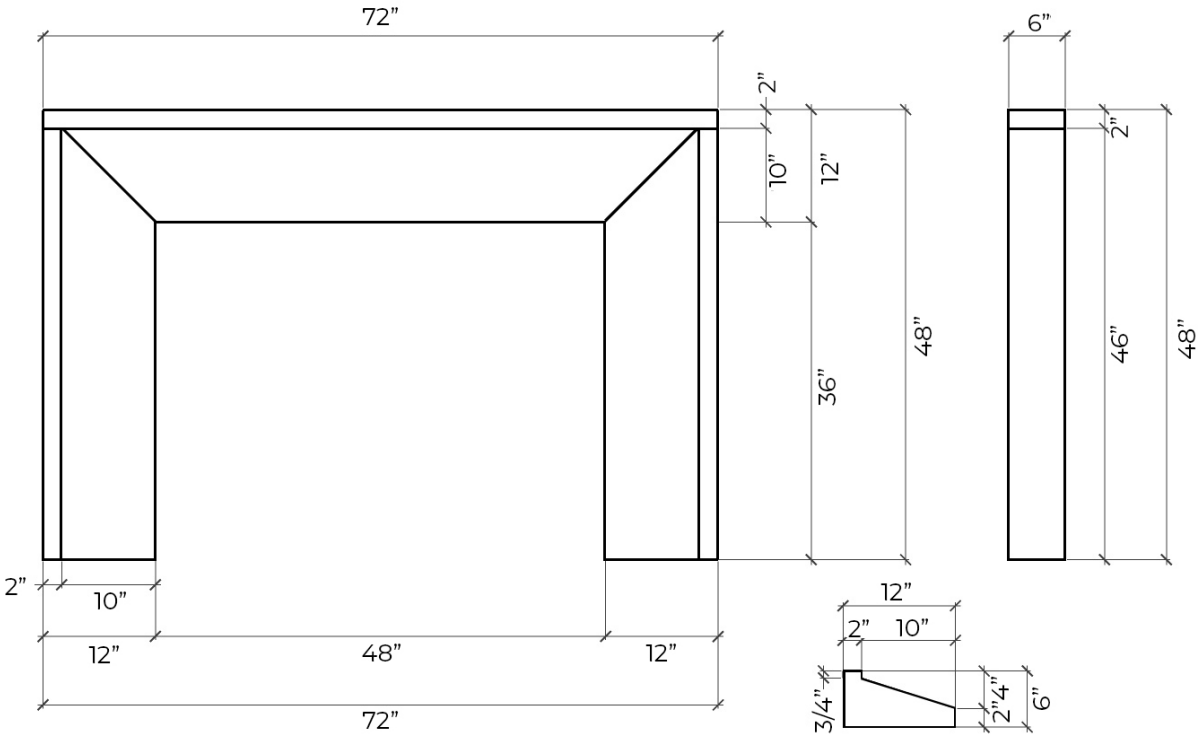





# Concrete Panels

## *Custom. Wall features.*

Our panels are available custom sizes to suit the many possible required wall areas. Panels can be used on fireplaces or on feature walls in entrances or art walls.

*Panels can be paired with floating mantels, or hearths or any surrounds for greater functionality.*



**Panels**  
Mist, Industrial  
shown with hearth





Panels w/Floating Mantel

Charcoal, Smoothcast





Panels  
London Fog, Smoothcast  
*shown with custom reveals*







## Panels

Moonlight, Smoothcast  
shown with custom mantel



# Definition Mantel

*Contemporary. Singular.*

With sharp lines and smooth planes the Definition mantel complements a minimalist aesthetic. The sectional assembly can be adjusted to work with most fireplace units.



Dimensions:

**UP TO 80"W x UP TO 60"H x 2"D**  
Custom width and depths available



**dreamcastdesign.com**

Visit our website for a full cutsheet and package details.

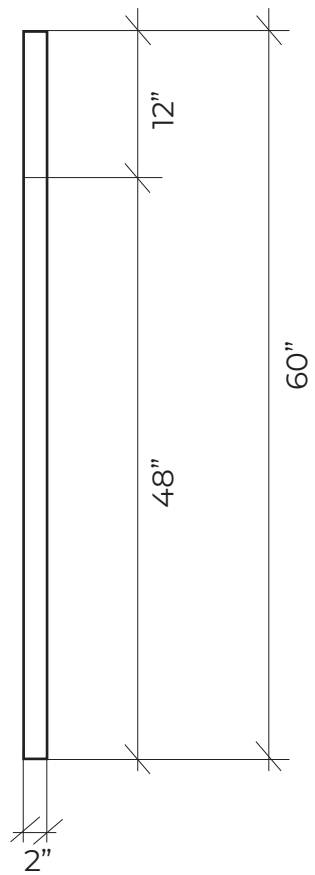
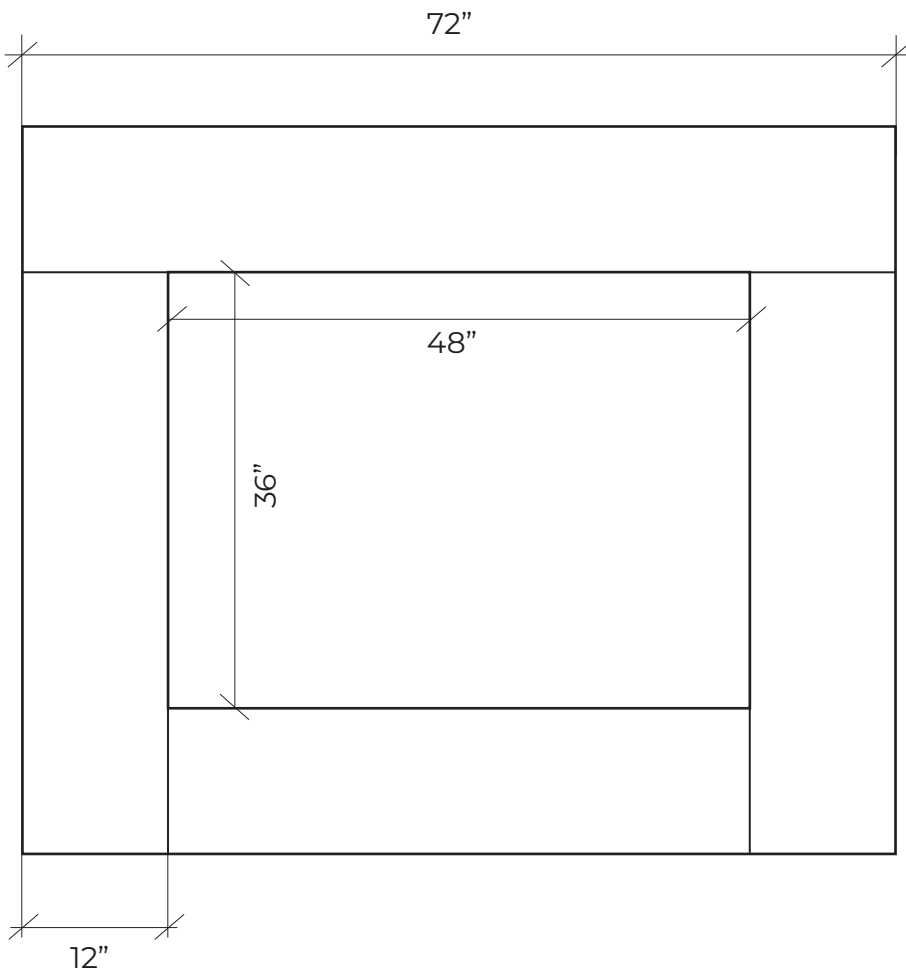

**Definition w/Floating Mantel**  
London Fog, Smoothcast





3pc Hearth  
Mist, Smoothcast

# Hearth Options

Hearth stones are available to complement any of our mantels. Our modern and traditional profiles come in a standard sized slab and are also available in attractive 3pc assemblies to create a required custom length or depth.

## Hearth Slab

Modern hearth - 72"L

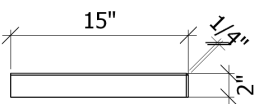
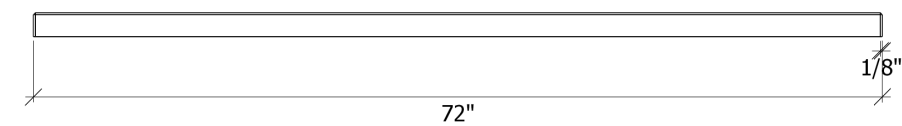

Classical hearth - 72"L

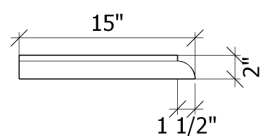
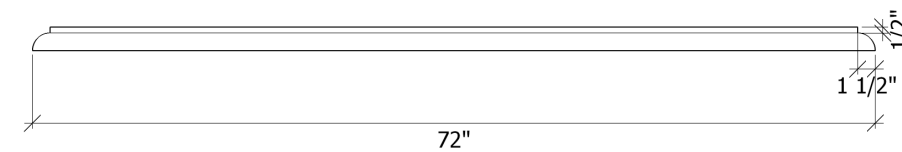

## 3pc Hearth Assemblies

These hearths can be 1" or 2" thick with a depth of up to 24" and length of up to 96"

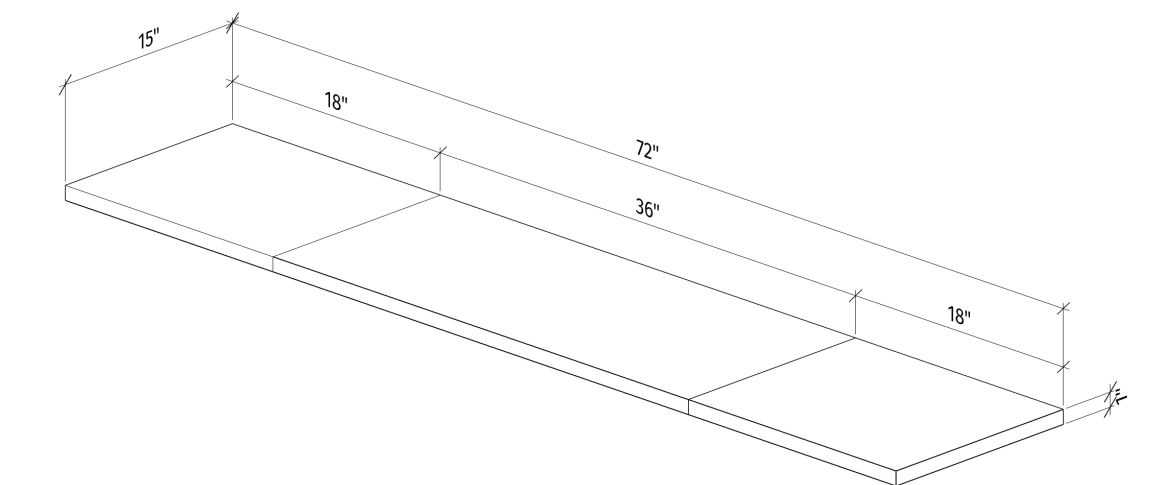

## Raised Hearths

Kick assemblies are required for raised hearths and produced in 5pcs panel assemblies just like hearths





Custom Mantel  
Chalk, Smoothcast



With **over a decade of expertise in fireplace design** we are familiar with the intricacies of ensuring modern fire appliances and stone perform together.

# DreamCast

## Bespoke Fireplace Service



**Dreamcast** is at its heart a custom production facility. We would love to collaborate with you to create a unique fireplace vision.



Custom Panels  
Moonlight, Smoothcast



For almost every owner of a modern house equipped with efficient heating systems, a fireplace has become a safe refuge from daily routine and stress.

Even if you don't use a fireplace as a heating element, it can be an essential decorative part of your attractive home.



Custom Mantel  
Simply White, Old World



Our well-established production facility allows us to offer competitive pricing and accelerated lead times on a range of projects.

By presenting a wide range of mantel designs, we manufacture surrounds that can fit almost every interior style. However, some projects require customization to satisfy homeowners' tastes and needs.

Our main goal is to present to a client a well-designed fireplace, cast with modern technologies with a reliable production method and utilizing sustainable materials.



Custom Mantel  
Cloud White, Limestone



# Colours & Textures

With a variety of colours to choose from we are sure to have the right combination for your living space. All colours are available in all textures.



**Please note that each colour will have a unique interpretation in each texture.**

 We highly recommend to order a colour sample prior to final selection.

## Concrete Colours

		
CHARCOAL	LONDON FOG	HAZE
		
CHOCOLATE	PORTOBELLO	MIST
		
MOONLIGHT	CHALK	CLOUD WHITE
		
SIMPLY WHITE	ICE WHITE	

## Concrete Textures

	
LIMESTONE	OLD WORLD
	
SMOOTH	



## Custom Colours *Unique Projects*

## Custom Concrete Colours

If you have a specific colour that you require for your project to achieve the perfect tonal harmony please contact us.

**We will work with you to produce the appropriate colour and produce samples for approval.**

Custom Mantel  
Mist, Old World







## Design Services

We are passionate about our products and design. If you have a query on how to make a standard design work in your space, or you are looking for a custom mantel our team of draftsmen, mould makers and industry professionals are at hand for assistance.

**If you are not working with a design professional one of our expert staff will personally guide you through the process for your perfect fireplace.**

### Product Installation

Our service takes you through to the very completion of your project. After shipping, our installation technicians are available by phone to take you step by step. Our technicians know our products and will be speaking to you based off years of experience.

**Local installation services are available.**

### Our Commitment

For over a decade we have produced architectural quality concrete details at our workshop in Richmond BC, Canada.

We have defined our craft - creating our trademark look with unique textures that take skill, expertise and patience. Concrete is a timeless material and demands no compromises in its process to ensure performance in high heat environments.

We are a family run business, and we ensure a meticulous approach that has guided our development of these mantels in their integrity of design.

We are proud that our mantels embody the finest in craftsmanship, and it is our hope that you will find the style that is just right for your space.

*We welcome you to join our family by the fire.*

Anna Traschenko  
President



### Warranty Information

All our concrete products are backed with a limited 1 year manufacturing warranty.

**Full warranty information available on our website.**





# DreamCast

*Design & Production*

*Want more inspiration?*

***See More...***

Visit the website for our image gallery,  
or email us for help to choose the  
perfect mantel for your space.

✉ [info@dreamcastdesign.com](mailto:info@dreamcastdesign.com)

🌐 [dreamcastdesign.com](http://dreamcastdesign.com)

☎ 1-888-616-4939

📍 2200 Vauxhall Place,  
Richmond, BC, V6V 1Z9,  
CANADA

📷 [dreamcastdesign](#)

DREAMCAST DESIGN AND PRODUCTION LTD