

# DreamCast Element 36



## DEFINITELY CHIC

Warm up your days with this versatile firepit. Featuring ample table space for greater functionality.

### Product Features/Specifications:

- 55K BTU Natural Gas
- 50K BTU Liquid Propane
- Complimentary Lava Rocks
- Other media available for purchase
- Manual Lit Ignition (available for upgrade to Electronic Ignition - please contact for further information)
- Weight: 198 lbs.
- Overhead clearance: 84" - 120" (depending on burner) and 36" horizontally to combustibles.

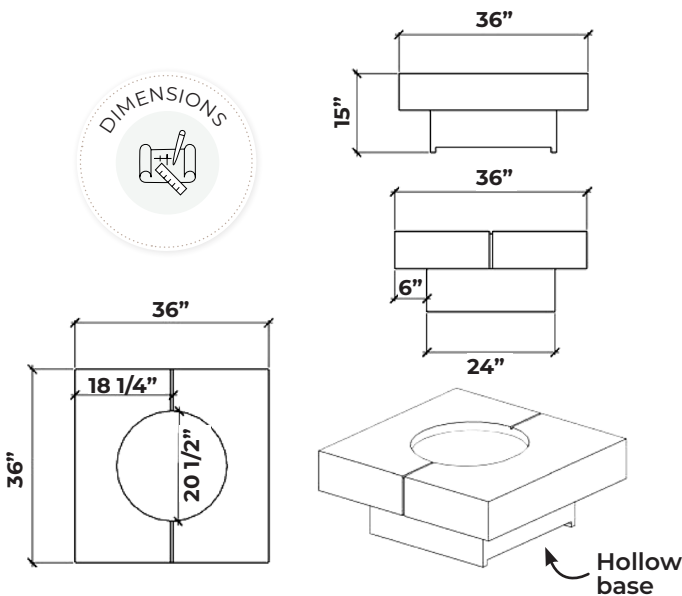
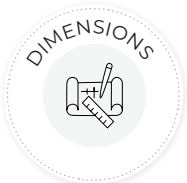

### Min. and Max. Gas Inlet Pressures:

The installer is responsible for using the correct fuel lines and/or regulation to provide gas to the fire feature within the specified minimum and maximum gas inlet pressures.

Refer to installation manual for further information

### Gas Inlet Pressures

Match Light	Minimum	Maximum
Natural Gas	3.5" W.C. (.8718Kpa)	7.0" W.C. (1.7436Kpa)
Liquid Propane	11.0" W.C. (2.7399 Kpa)	13.0" W.C. (3.2381 Kpa)



**DreamCast**  
Design & Production

Please contact us at **1-604-278-4939** with any questions. We also encourage you to explore our website at [www.dreamcastdesign.com](http://www.dreamcastdesign.com)

Our experienced team can assist you with product information, installation and design recommendations.

# Element 36

## DreamCast

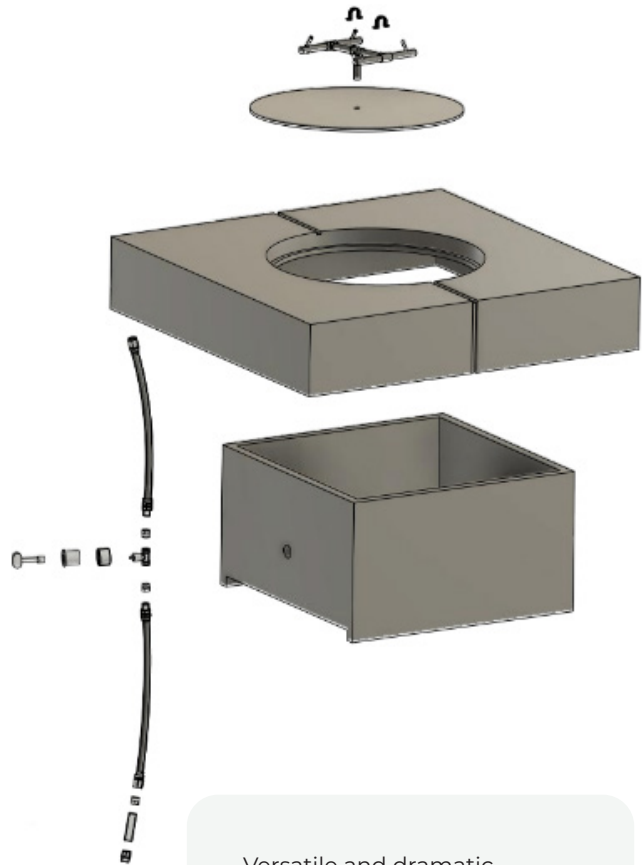
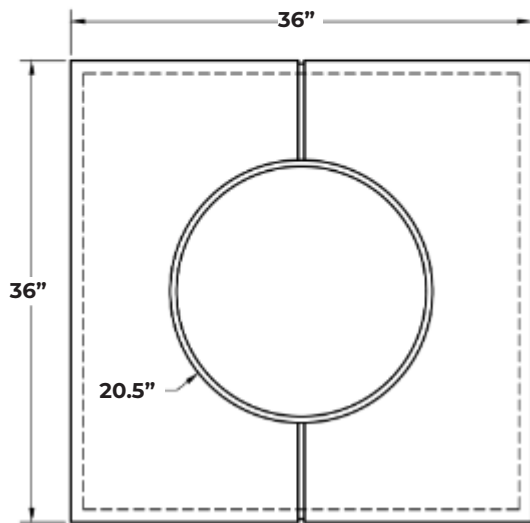
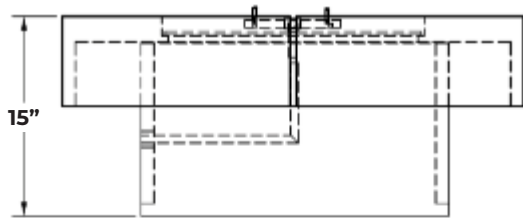

Versatile and dramatic the Element Firetable is a contemporary focal point. This fire table offers room for entertainment and is still compact enough to work in smaller spaces.

**DreamCast**  
Design & Production

Please contact us at [1-604-278-4939](tel:1-604-278-4939) with any questions. We also encourage you to explore our website at [www.dreamcastdesign.com](http://www.dreamcastdesign.com)

Our experienced team can assist you with product information, installation and design recommendations.