

# Bowen

Three sided

62" Standard

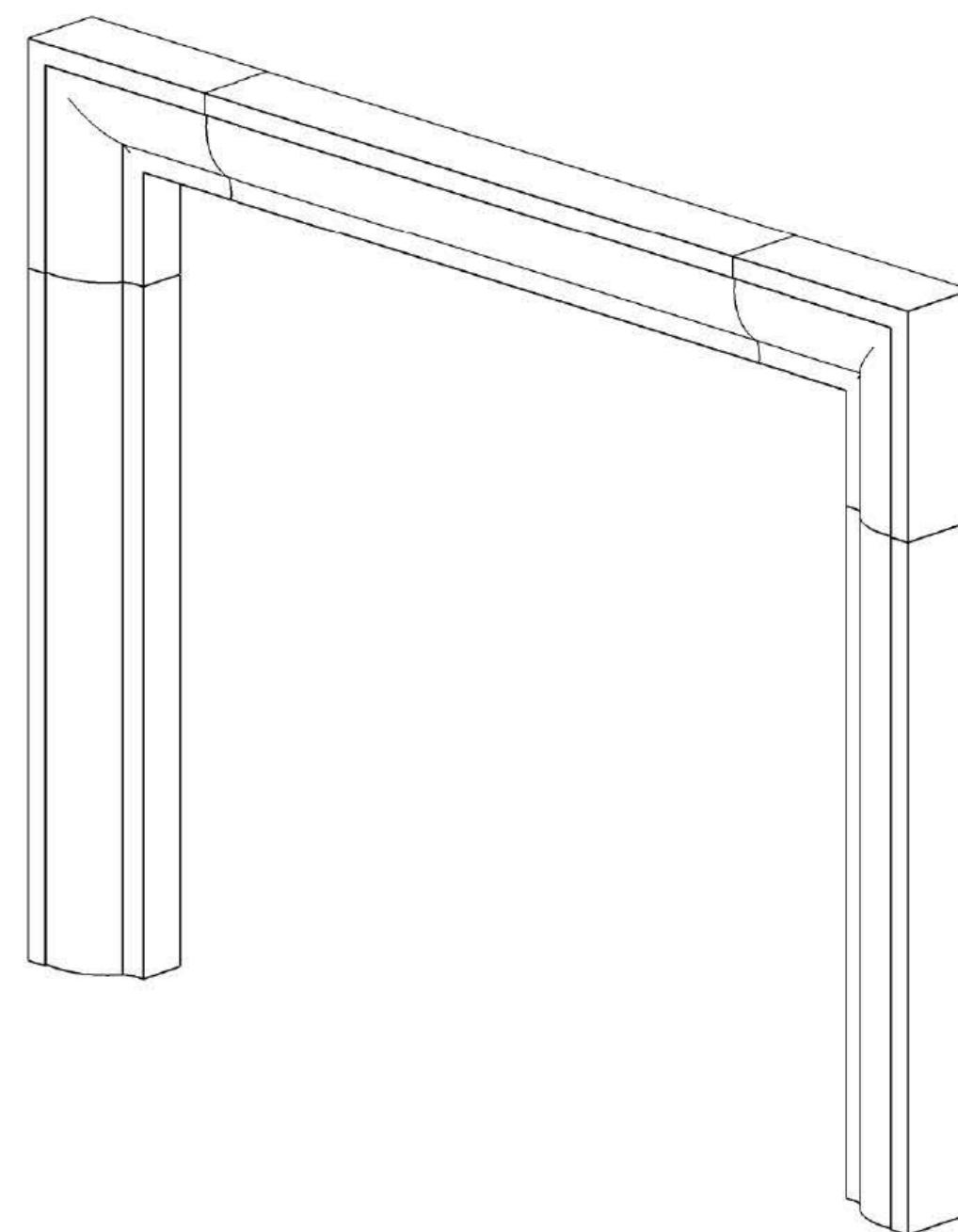
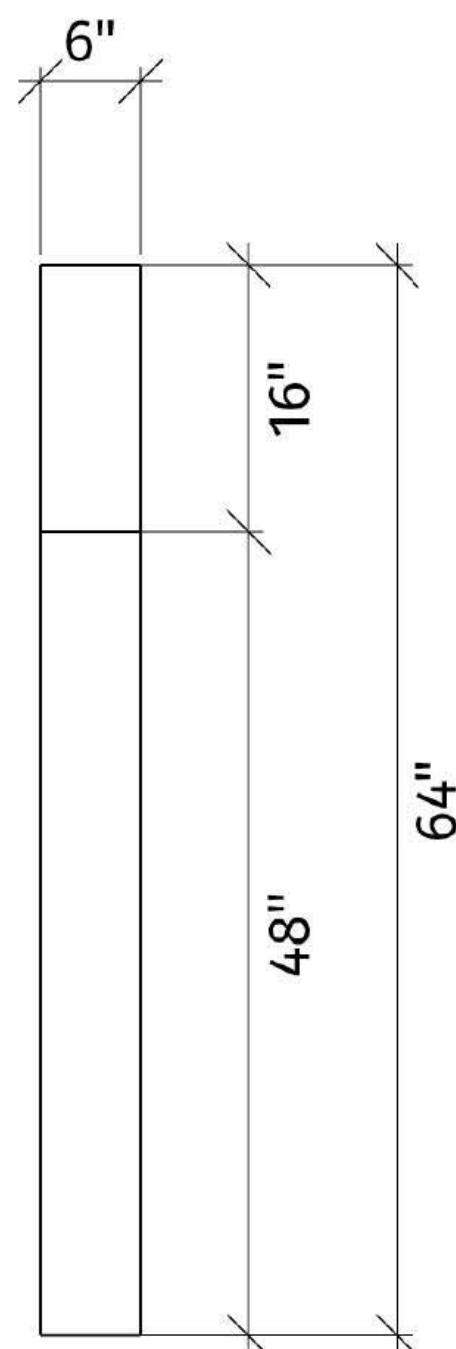
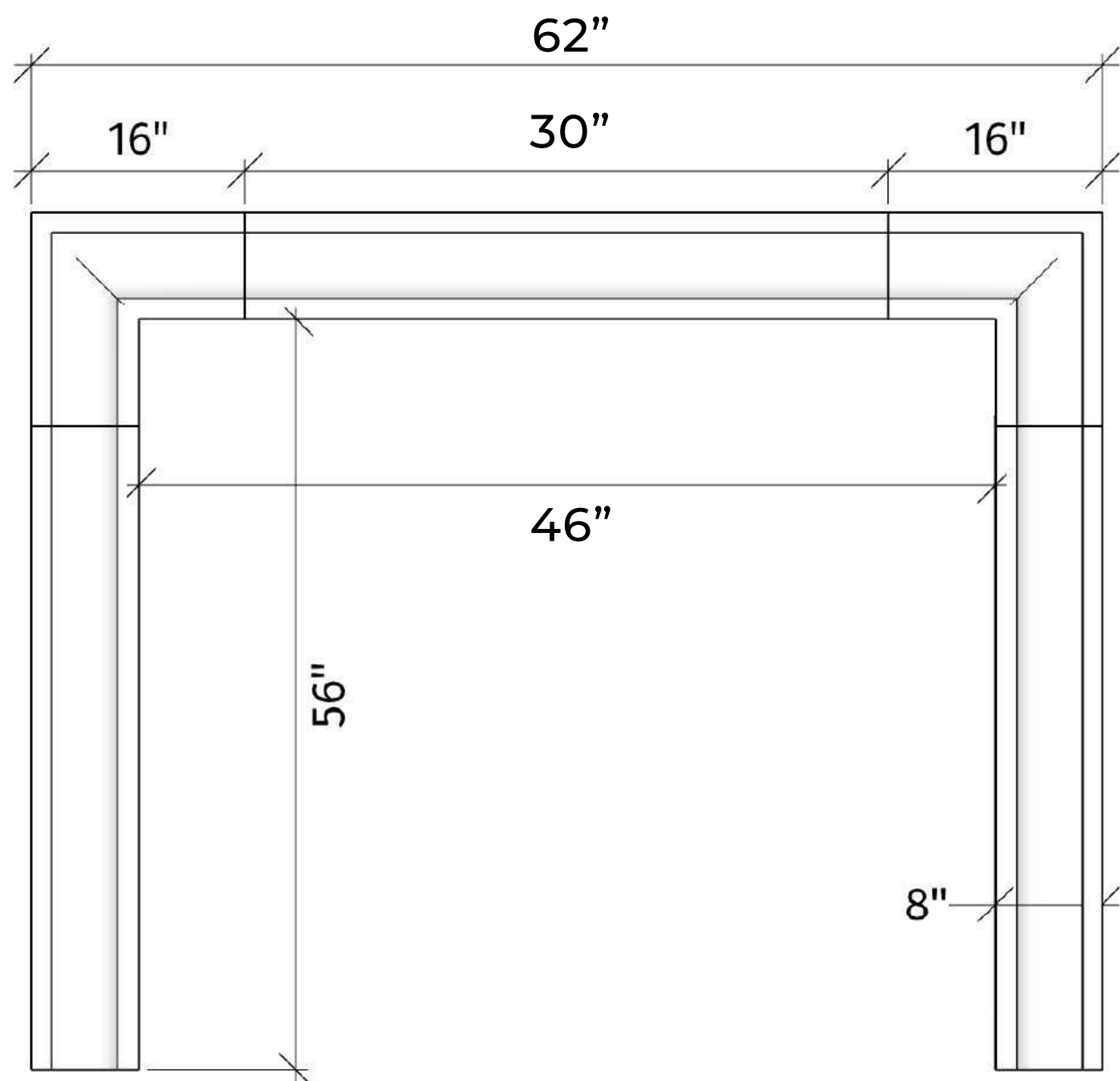

*Transitional. Clean.*



Blending the soft curves of classic architecture with a bold picture frame approach the **Bowen mantel** design easily works into many interior styles.

## Bowen

**PACKAGE INCLUDES:**

- Concrete mantel, legs
  - Concrete infill panels
  - Colour-matched caulking
- Surrounds ship pre-sealed*

**DreamCast**  
Design & Production

Please contact us at **1-604-278-4939** with any questions.

We also encourage you to explore our website at [www.dreamcastdesign.com](http://www.dreamcastdesign.com)

Our experienced team can assist you with product information, installation and design recommendations.



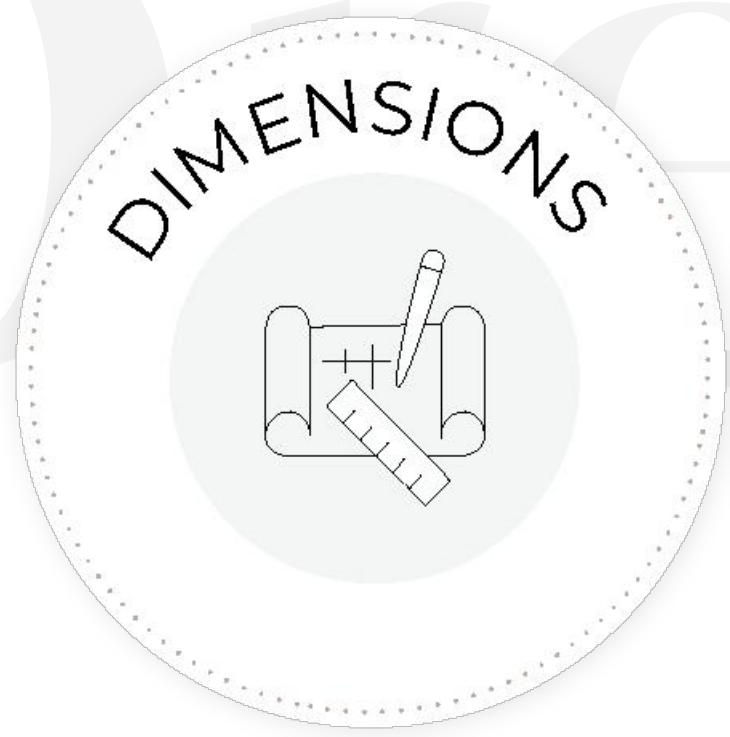

# Bowen

Four sided

62" Standard

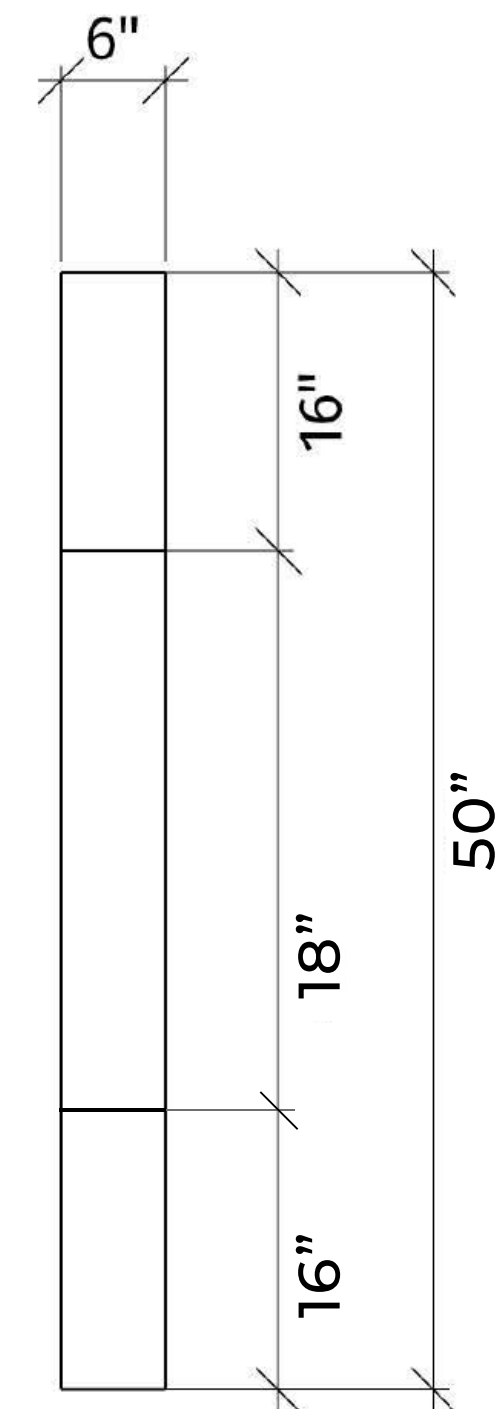
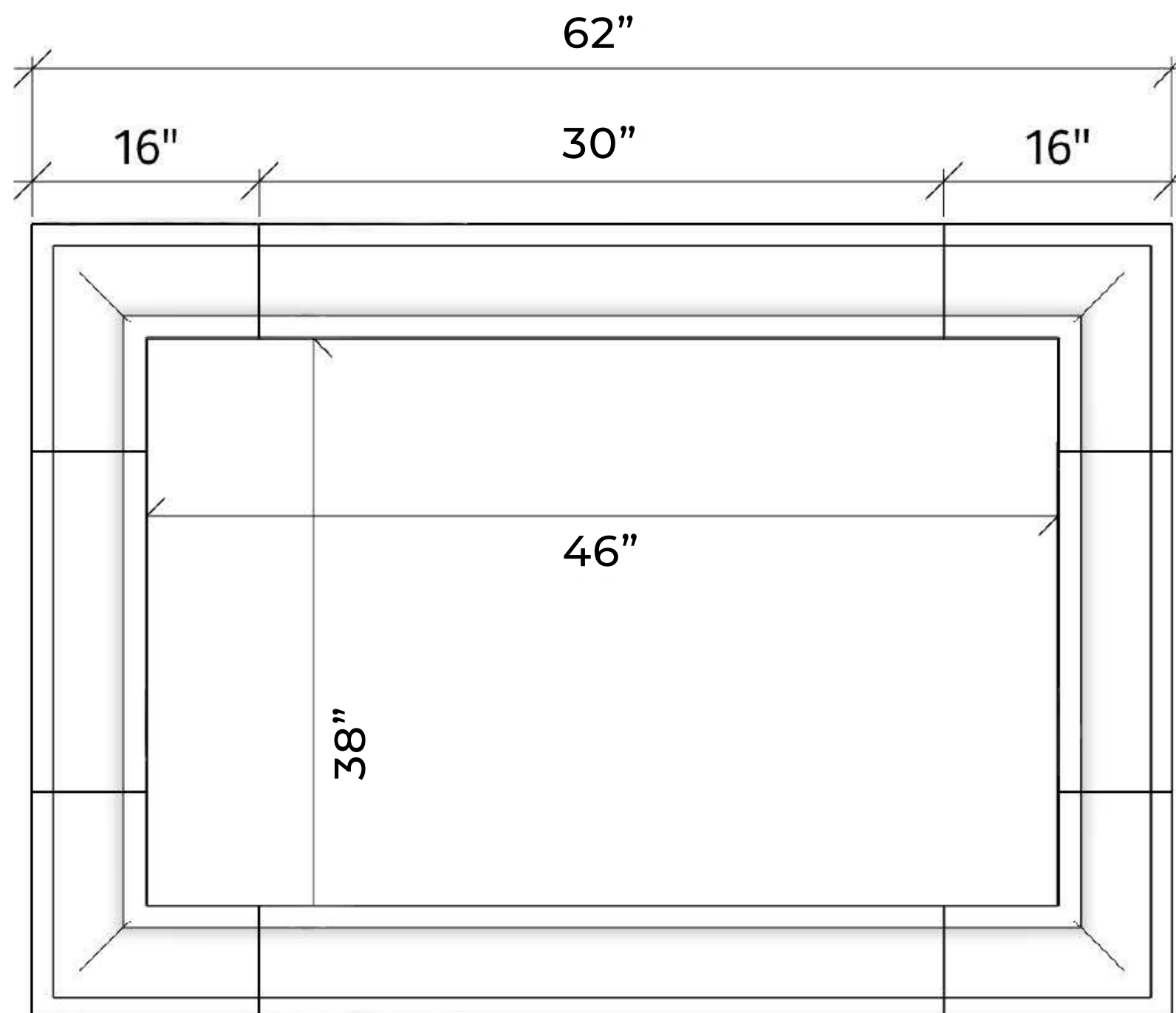

*Transitional. Clean.*



Blending the soft curves of classic architecture with a bold picture frame approach the **Bowen mantel** design easily works into many interior styles.

## Bowen

**PACKAGE  
INCLUDES:**

- Concrete mantel, legs
  - Concrete infill panels
  - Colour-matched caulking
- Surrounds ship pre-sealed*

**DreamCast**  
Design & Production

Please contact us at **1-604-278-4939** with any questions.

We also encourage you to explore our website at [www.dreamcastdesign.com](http://www.dreamcastdesign.com)

Our experienced team can assist you with product information, installation and design recommendations.



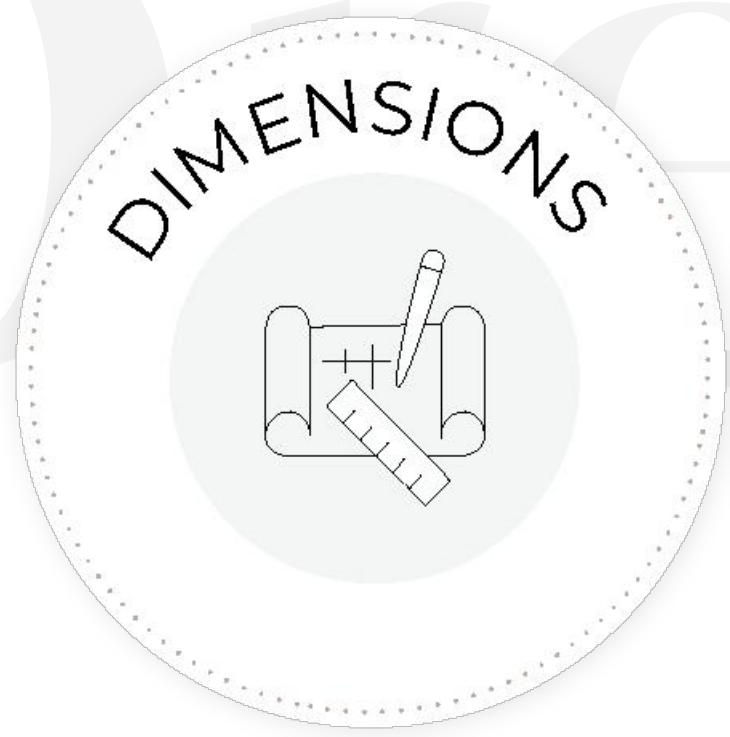

# Bowen

Three sided

76" Standard

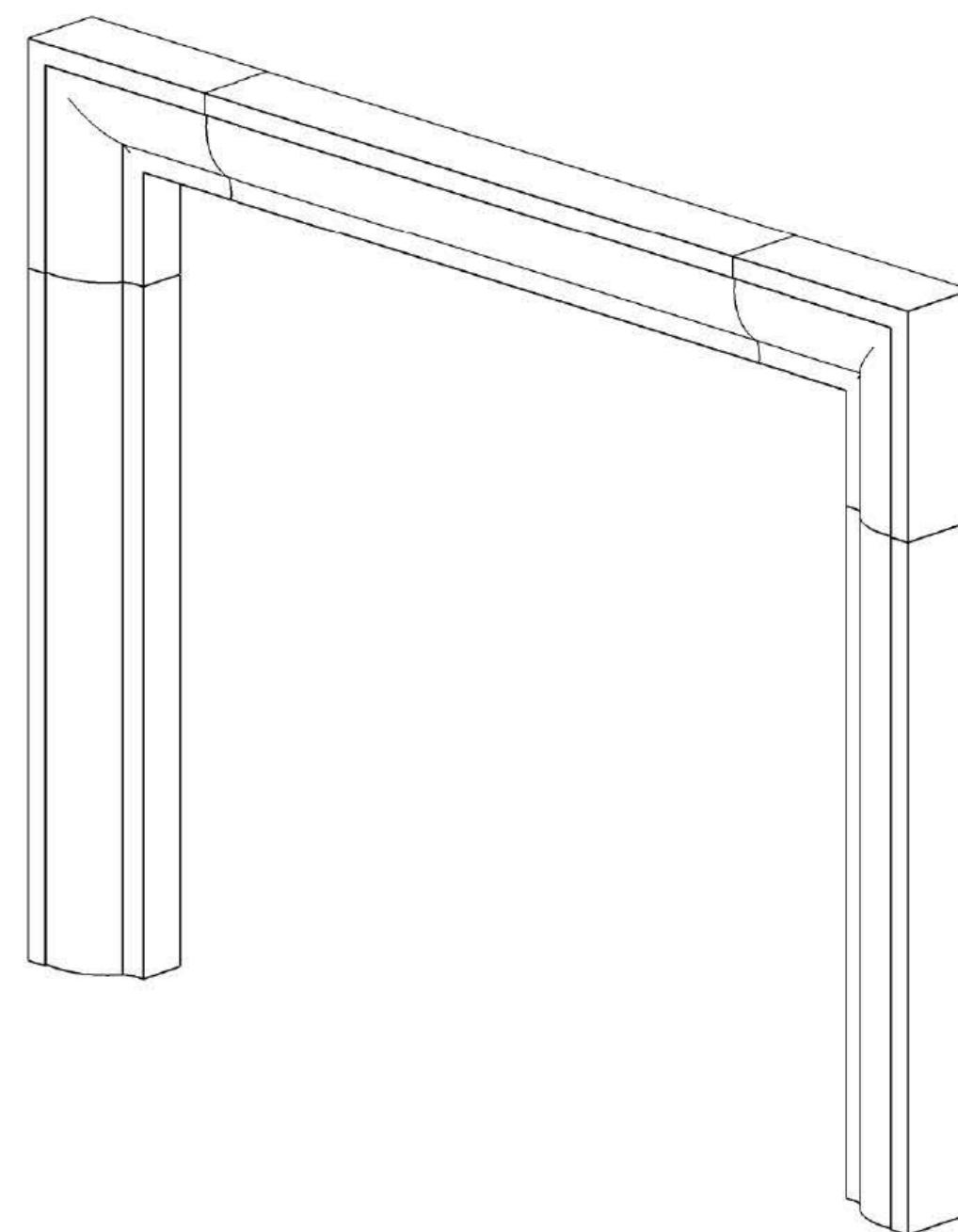
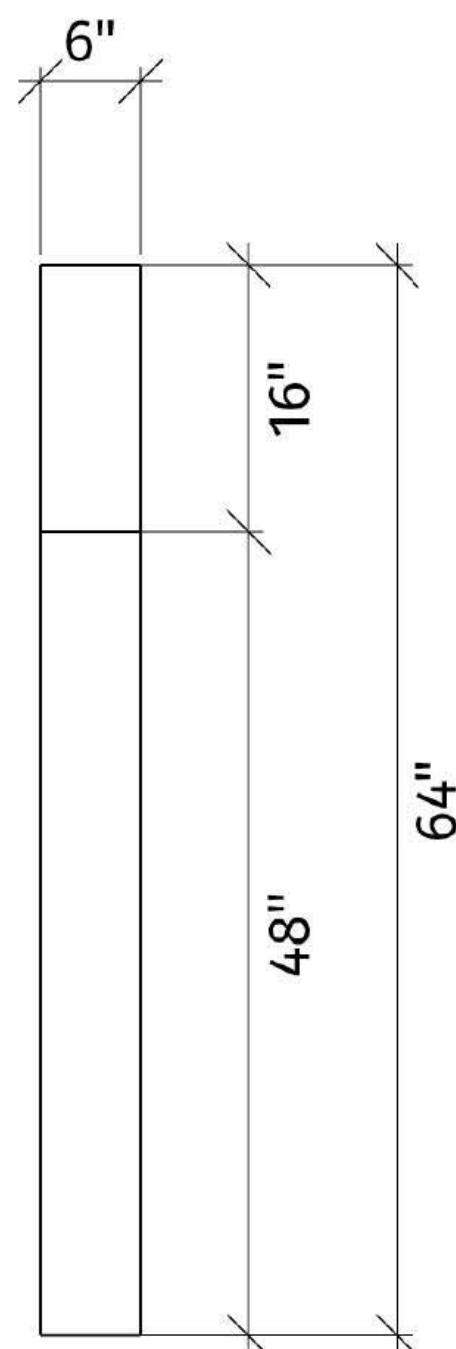
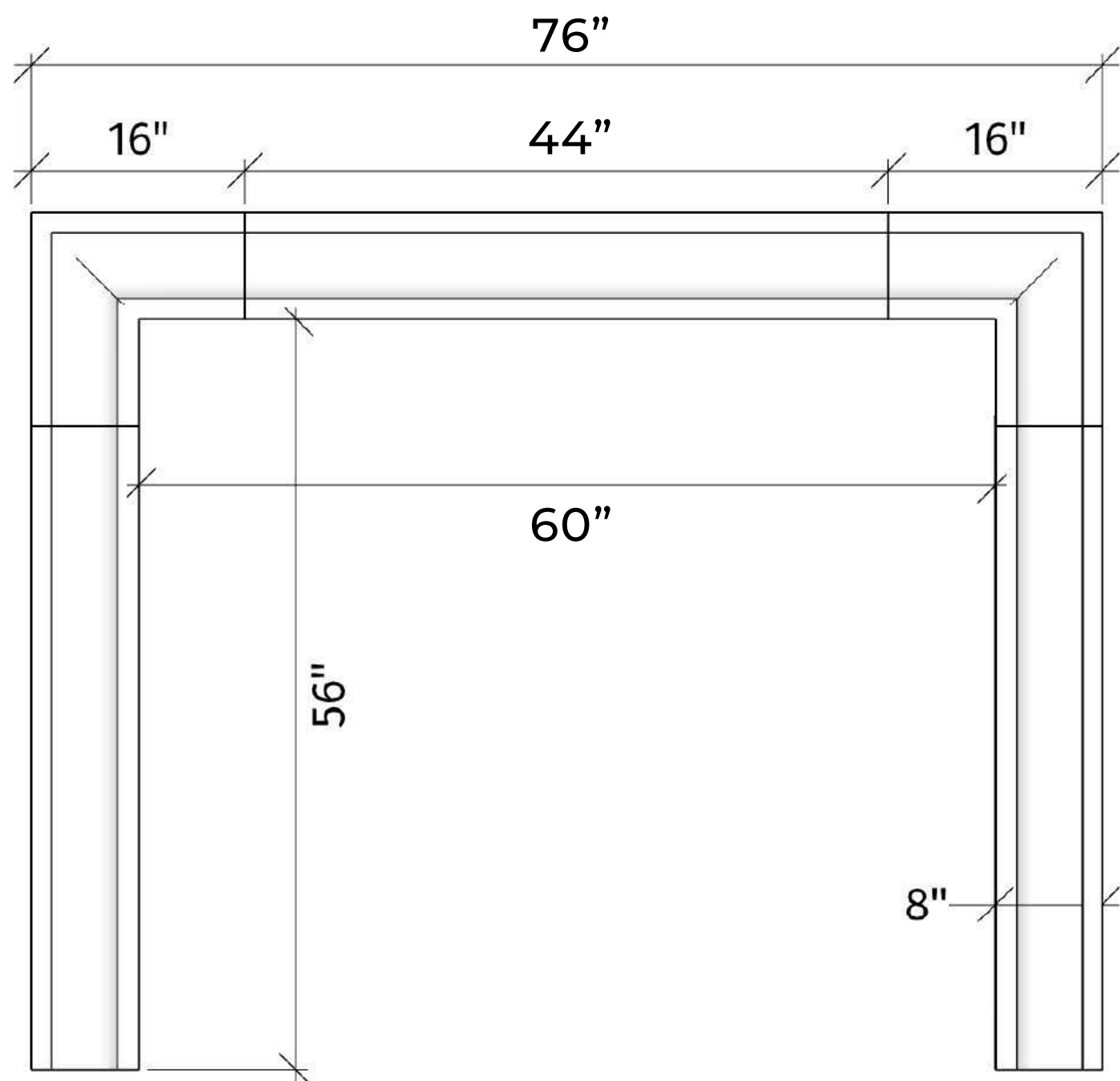

*Transitional. Clean.*



Blending the soft curves of classic architecture with a bold picture frame approach the **Bowen mantel** design easily works into many interior styles.

## Bowen

**PACKAGE INCLUDES:**

- Concrete mantel, legs
  - Concrete infill panels
  - Colour-matched caulking
- Surrounds ship pre-sealed*

**DreamCast**  
Design & Production

Please contact us at **1-604-278-4939** with any questions.

We also encourage you to explore our website at [www.dreamcastdesign.com](http://www.dreamcastdesign.com)

Our experienced team can assist you with product information, installation and design recommendations.



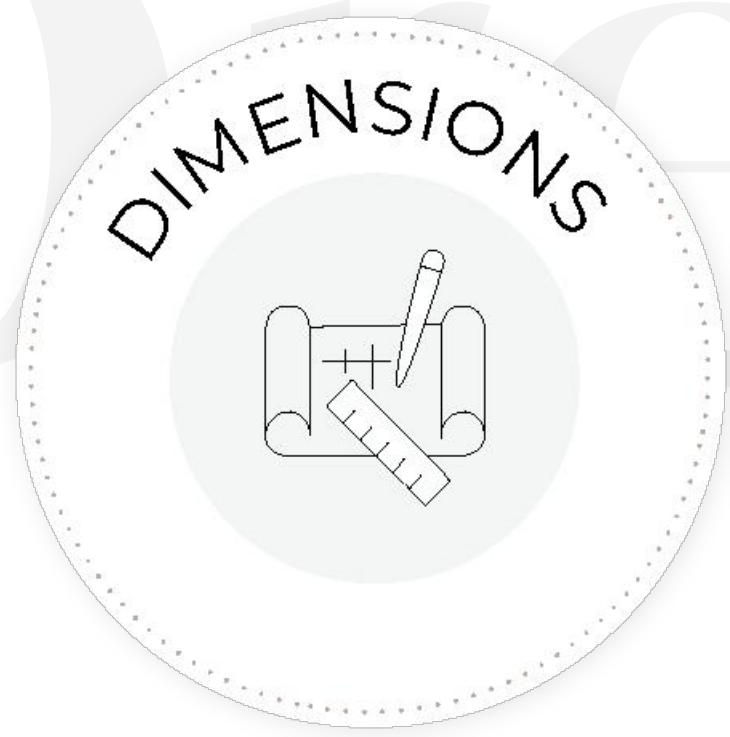

# Bowen

Four sided

76" Standard

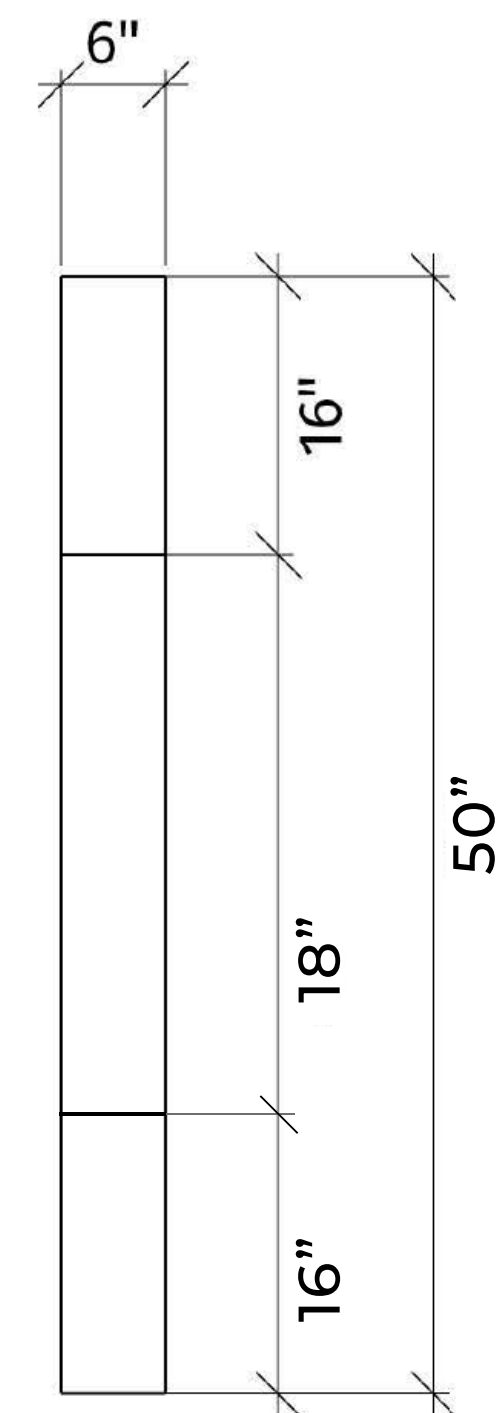
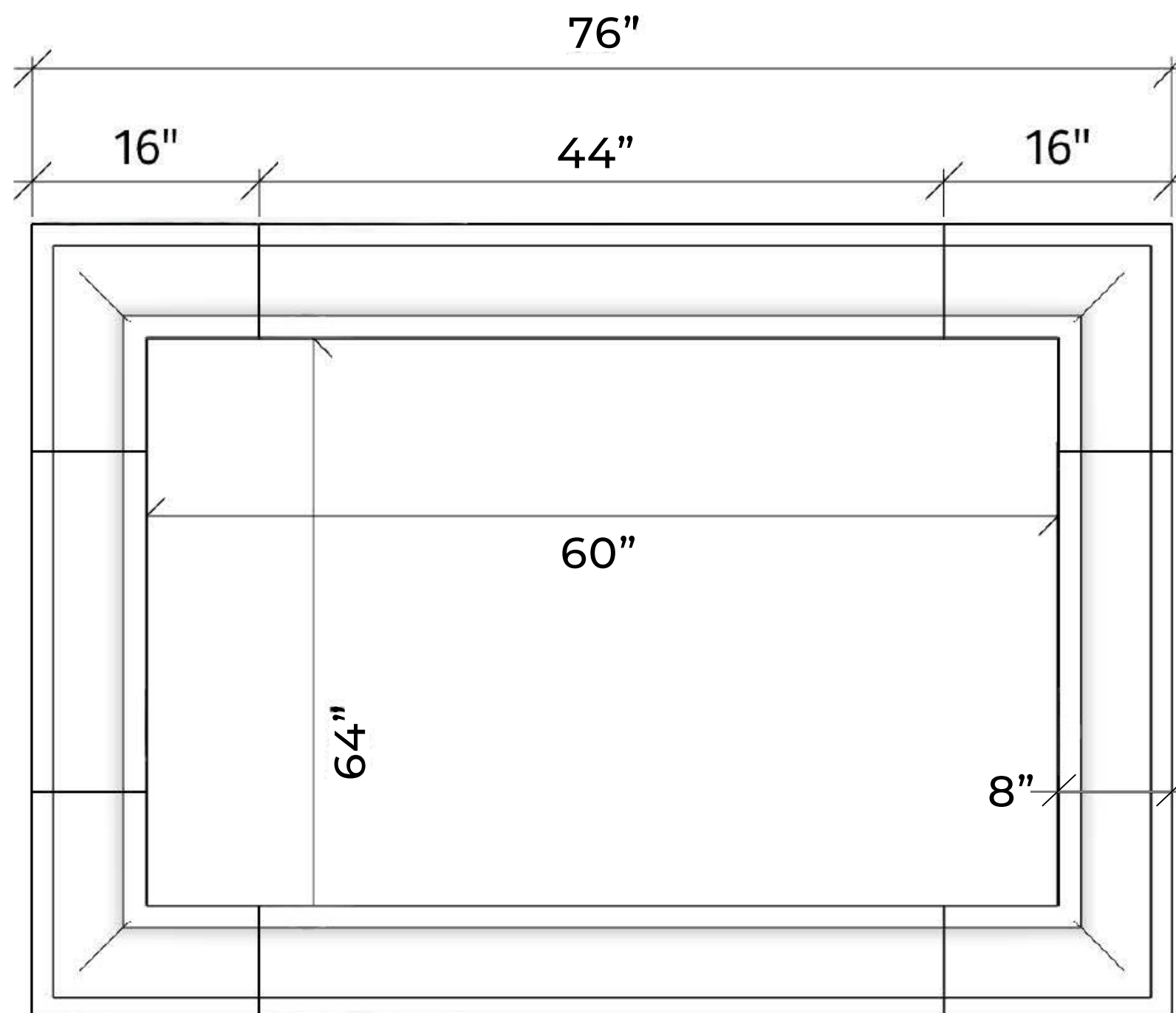

*Transitional. Clean.*



Blending the soft curves of classic architecture with a bold picture frame approach the **Bowen mantel** design easily works into many interior styles.

## Bowen

**PACKAGE  
INCLUDES:**

- Concrete mantel, legs
  - Concrete infill panels
  - Colour-matched caulking
- Surrounds ship pre-sealed*

**DreamCast**  
Design & Production

Please contact us at **1-604-278-4939** with any questions.

We also encourage you to explore our website at [www.dreamcastdesign.com](http://www.dreamcastdesign.com)

Our experienced team can assist you with product information, installation and design recommendations.